

User Guide

RP-BE58

BE3600 Dual-Band WiFi Range Extender

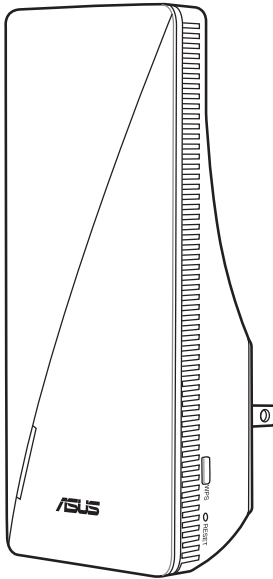

E25325

First Edition

February 2025

Copyright © 2025 ASUSTeK Computer Inc. All Rights Reserved.

No part of this manual, including the products and software described in it, may be reproduced, transmitted, transcribed, stored in a retrieval system, or translated into any language in any form or by any means, except documentation kept by the purchaser for backup purposes, without the express written permission of ASUSTeK Computer Inc. ("ASUS").

Product warranty or service will not be extended if: (1) the product is repaired, modified or altered, unless such repair, modification or alteration is authorized in writing by ASUS; or (2) the serial number of the product is defaced or missing.

ASUS PROVIDES THIS MANUAL "AS IS" WITHOUT WARRANTY OF ANY KIND, EITHER EXPRESS OR IMPLIED, INCLUDING BUT NOT LIMITED TO THE IMPLIED WARRANTIES OR CONDITIONS OF MERCHANTABILITY OR FITNESS FOR A PARTICULAR PURPOSE. IN NO EVENT SHALL ASUS, ITS DIRECTORS, OFFICERS, EMPLOYEES OR AGENTS BE LIABLE FOR ANY INDIRECT, SPECIAL, INCIDENTAL, OR CONSEQUENTIAL DAMAGES (INCLUDING DAMAGES FOR LOSS OF PROFITS, LOSS OF BUSINESS, LOSS OF USE OR DATA, INTERRUPTION OF BUSINESS AND THE LIKE), EVEN IF ASUS HAS BEEN ADVISED OF THE POSSIBILITY OF SUCH DAMAGES ARISING FROM ANY DEFECT OR ERROR IN THIS MANUAL OR PRODUCT.

SPECIFICATIONS AND INFORMATION CONTAINED IN THIS MANUAL ARE FURNISHED FOR INFORMATIONAL USE ONLY, AND ARE SUBJECT TO CHANGE AT ANY TIME WITHOUT NOTICE, AND SHOULD NOT BE CONSTRUED AS A COMMITMENT BY ASUS. ASUS ASSUMES NO RESPONSIBILITY OR LIABILITY FOR ANY ERRORS OR INACCURACIES THAT MAY APPEAR IN THIS MANUAL, INCLUDING THE PRODUCTS AND SOFTWARE DESCRIBED IN IT.

Products and corporate names appearing in this manual may or may not be registered trademarks or copyrights of their respective companies, and are used only for identification or explanation and to the owners' benefit, without intent to infringe.

Table of contents

1 Getting to know your wireless router

1.1 Welcome!.....4

1.2 Package contents4

1.3 Your wireless range extender5

1.4 Positioning your wireless range extender7

2 Getting started

2.1 Set up RP-BE58 as a WiFi range extender.....8

 A. via App 8

 B. via WPS 9

2.2 Set up RP-BE58 as an AiMesh Node 10

3 Tutorial

 AiMesh..... 12

 Firmware upgrade/reset/restore..... 12

 Guest network 12

 LAN 12

 Operation mode..... 12

 Security..... 13

 Setup / Login..... 13

 Troubleshooting of Internet and Wi-Fi 13

 Wi-Fi 13

Appendices

Safety Notices..... 15

Service and Support..... 17

1 Getting to know your wireless router

1.1 Welcome!

Thank you for purchasing an ASUS RP-BE58 Wireless Range Extender!

Featuring WiFi 7, RP-BE58 delivers speeds of up to 3600Mbps, enhancing performance by 20% compared to WiFi 6. Additionally, it supports AiMesh technology, ensuring a stable, seamless, and secure wireless connection with compatible devices throughout your home. Its compatibility with virtually all WiFi routers further extends coverage.

1.2 Package contents

- ☒ RP-BE58 Wireless Range Extender
- ☒ Quick Start Guide

NOTES:

- If any of the items are damaged or missing, contact ASUS for technical inquiries and support. Refer to **Service and Support** at the back of this user manual.
 - Keep the original packaging material in case you would need future warranty services such as repair or replacement.
-

1.3 Your wireless range extender

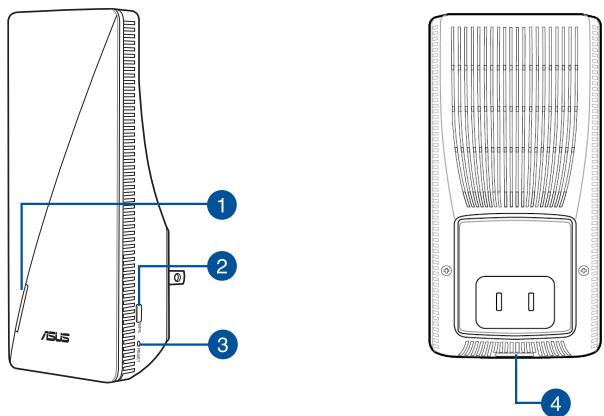

-
- 1 Power LED**
Refer to **LED Explanations** on the next page for details.
 - 2 WPS button**
This button launches the WPS Wizard.
 - 3 Reset button**
This button resets or restores the system to its factory default settings.
 - 4 LAN port**
Connect a network cable into this port to establish LAN connection.
-

NOTE:

- **Specifications:**

AC Power board	AC Input: 100V~240V		
Operating Temperature	0~40°C	Storage	0~70°C
Operating Humidity	50~90%	Storage	20~90%

LED Explanations

WiFi Range Extender Mode	
Status	LED Behavior
Booting up	Blinking White
Booting up complete (not connected to Router)	Solid Blue
Reset (use a pin to press the reset button for 5 seconds)	Blinking Yellow
Rescue mode	Solid Purple
Starting WPS	Blinking Blue
Connected to the router with Good Signal	Solid White
Connected to the router with Weak Signal	Solid Yellow
No signal	Solid Red
AP mode (with wired connection)	Solid White
AP mode (without wired connection)	Solid Red

AiMesh Mode	
Status	LED Behavior
Booting up	Blinking White
Booting up complete (not connected to AiMesh Router)	Solid Blue
Reset (use a pin to press the reset button for 5 seconds)	Blinking Yellow
Rescue mode	Solid Purple
Connecting to the AiMesh Router	Blinking Blue
Connected to the AiMesh Router with Good Signal	Solid White
Connected to the AiMesh Router with Weak Signal	Solid Yellow
No signal	Solid Red
Ethernet backhaul	Solid White

1.4 Positioning your wireless range extender

For optimal wireless transmission between the wireless range extender and connected wireless devices, ensure that you:

- Plug your RP-BE58 into a power outlet near your router/AP.
- Check the LEDs and see the **LED Explanations**.
- Wait for the LED to flash and turn solid blue, indicating that your RP-BE58 is ready to connect to your existing router/AP.

NOTES:

- To minimize interference, keep the routers away from devices like cordless phones, Bluetooth devices and microwave ovens.
 - We recommend that you place the routers in an open or spacious location.
-
- Always update to the latest firmware. Visit the ASUS website at <https://www.asus.com> to get the latest firmware updates.

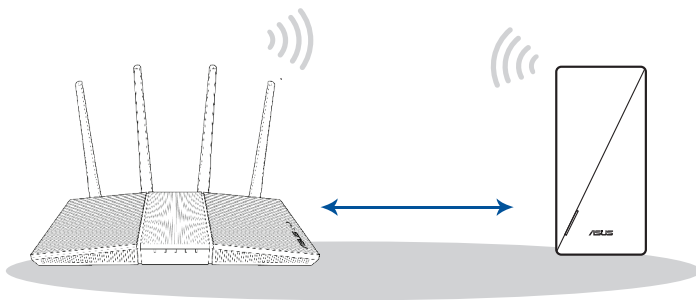

2 Getting started

2.1 Set up RP-BE58 as a WiFi range extender

WARNING! Use this product in environments with ambient temperatures between 0°C (32°F) and 40°C (104°F).

If you would like to connect RP-BE58 to other WiFi networks excluding AiMesh-supported routers, please download the **ASUS Extender** app or set up with the WPS button.

A. via App

Download the ASUS Extender app and follow the onscreen instructions.

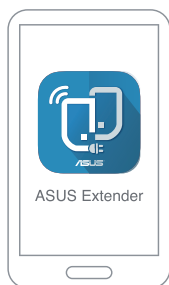

B. via WPS

1. Press the WPS button on your router/AP.

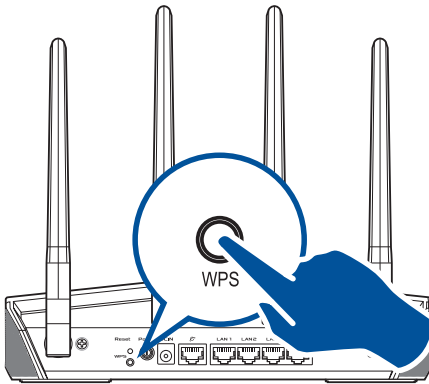

2. Press the WPS button on your RP-BE58 for more than two (2) seconds until the LED starts to blink blue.

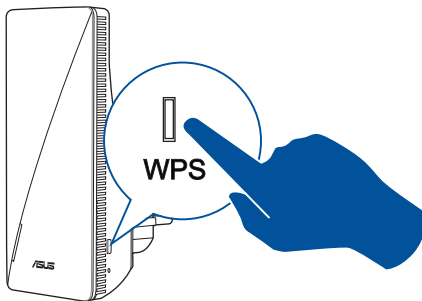

2.2 Set up RP-BE58 as an AiMesh Node

If you already have an AiMesh router and you are going to create an AiMesh system, please download and install **ASUS Router** app for RP-BE58 setup.

1. Download the ASUS Router app.



2. Follow the onscreen instructions to set up your AiMesh router.
3. Tap **+** and select **Add AiMesh node**.

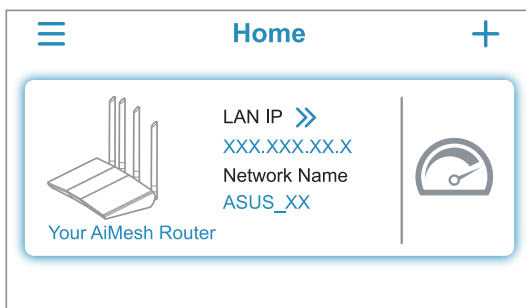

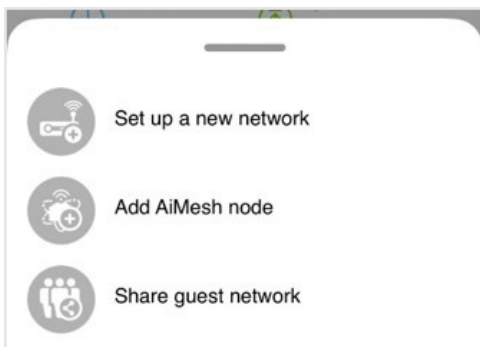

4. Select **RP-BE58** and follow the onscreen instructions to complete the setup.

NOTE: Set up a password for your router to prevent unauthorized access.

3 Tutorial

AiMesh

How to set up a range extender (RP series) as an AiMesh node?

How to improve the signal quality between your AiMesh router and AiMesh node?

Firmware upgrade/reset/restore

ASUS router's Hard Factory Reset

How to use Rescue Mode (Firmware Restoration)?

How to upgrade the firmware of my ASUS router to the latest version (Web GUI)?

Firmware upgrade failed.

How to upload the configuration files of my ASUS router?

How to save System Log in my ASUS router?

Why can't I sometimes download or update the operating system on my iPhone or Mac?

Guest network

How to set up a Guest Network?

LAN

How to set up LAN IP?

Operation mode

How many AiMesh nodes are suggested in an AiMesh system?

How to set up Access Point (AP) mode on an ASUS range extender device?

Security

Ways to achieve network security

Setup / Login

How to set up ASUS repeater with ASUS Extender app?

How to set repeater mode on the ASUS wireless range extender (WebGUI)?

How to use ASUS Device Discovery to find the IP address of an ASUS router?

How to find the IP address of your wireless router or AP from Windows system?

How to find the IP address of your wireless router or AP from iOS system?

How to find the IP address of your wireless router or AP from Android system?

Troubleshooting of Internet and Wi-Fi

How can I find the best location for my WiFi range extender?

Why is the wireless name of range extender different from my WiFi router?

The wireless router or wireless range extender often disconnects when operating in repeater mode.

Wi-Fi

What's the difference between 2.4GHz and 5GHz?

WiFi connection often disconnects.

How to forget WiFi connection password on Windows/MacOS/Android/iOS?

How to set up WPS connection?

Why does the WPS connection fail when using WPA3-Personal?

Appendices

Safety Notices

When using this product, always follow the fundamental safety precautions, including, but not limited to the following:



WARNING!

- Use this product in environments with ambient temperatures between 0°C (32°F) and 40°C (104°F).
 - Read the operational guidelines and the temperature range provided before using the product.
 - Pay particular attention to the personal safety when using this device in airports, hospitals, gas stations and professional garages.
 - Medical device interference: Maintain a minimum distance of at least 15 cm (6 inches) between implanted medical devices and ASUS products to reduce the risk of interference.
 - Kindly use ASUS products in good reception conditions to minimize the radiation's level.
 - Keep the device away from pregnant women and the lower abdomen of the teenager.
 - DO NOT use this product if visible defects can be observed or it has been wet or damaged or modified. Seek servicing for assistance.
-



WARNING!

- DO NOT place or drop objects on the top of the product. Avoid exposing the product to mechanical shock such as crushing, bending, puncturing or shredding.
 - DO NOT disassemble, open, microwave, incinerate, paint, or shove any foreign objects into this product.
 - Keep the product away from fire and heat sources.
 - DO NOT expose to or use near liquids, rain, or moisture. DO NOT use the product during electrical storms.
 - Connect the PoE output circuits of this product exclusively to PoE networks, without routing to external facilities.
 - To prevent electrical shock hazard, disconnect the power cable from the electrical outlet before relocating the system.
 - Only use accessories that have been approved by the device manufacturer to work with this model. The use of other types of accessories may invalidate the warranty or violate local regulations and laws, and may pose safety risks. Contact your local retailer for the availability of authorized accessories.
 - Use of this product in a way not recommended in the provided instructions may result in a risk of fire or personal injury.
-

Service and Support

Visit our multi-language website at
<https://www.asus.com/support>.

