

Canon

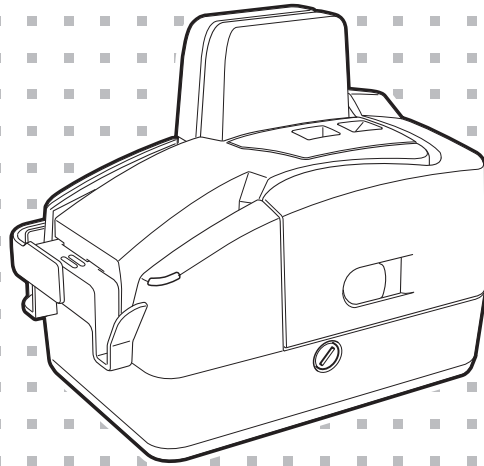

**imageFORMULA
CR-L1**

User Manual



◆ Please read this manual before operating this scanner.

FCC REGULATIONS (For 120V model)

Check Reader, Model 6130110/6130120

This device complies with Part 15 of the FCC Rules. Operation is subject to the following two conditions: (1) This device may not cause harmful interference, and (2) this device must accept any interference received, including interference that may cause undesired operation.

Note: This equipment has been tested and found to comply with the limits for a Class B digital device, pursuant to Part 15 of the FCC Rules. These limits are designed to provide reasonable protection against harmful interference in a residential installation. This equipment generates, uses, and can radiate radio frequency energy and, if not installed and used in accordance with the instructions, may cause harmful interference to radio communications. However, there is no guarantee that interference will not occur in a particular installation. If this equipment does cause harmful interference to radio or television reception, which can be determined by turning the equipment off and on, the user is encouraged to try to correct the interference by one or more of the following measures:

- Reorient or relocate the receiving antenna.
- Increase the separation between the equipment and receiver.
- Connect the equipment into an outlet on a circuit different from that to which the receiver is connected.
- Consult the dealer or an experienced radio/TV technician for help.

Use of shielded cable is required to comply with class B limits in Subpart B of Part 15 of FCC Rules.

Do not make any changes or modifications to the equipment unless otherwise specified in the manual. If such changes or modifications should be made, you could be required to stop operation of the equipment.

Canon U.S.A. Inc.

One Canon Park, Melville, NY 11747, U.S.A.

Tel. No. (800)652-2666

RADIO INTERFERENCE REGULATIONS (For 120V models)

This digital apparatus does not exceed the Class B limits for radio noise emissions from digital apparatus as set out in the interference-causing equipment standard entitled "Digital Apparatus", ICES-003 of the Industry Canada.

RÈGLEMENT SUR LE BROUILLAGE RADIOÉLECTRIQUE (For 120V models)

Cet appareil numérique respecte les limites de bruits radioélectriques applicables aux appareils numériques de Classe B prescrites dans la norme sur le matériel brouilleur: "Appareils Numériques", NMB-003 édictée par l'Industrie Canada.

International ENERGY STAR® Office Equipment Program



As an ENERGY STAR® Partner, CANON ELECTRONICS INC. has determined that this machine meets the ENERGY STAR® Program guidelines for energy efficiency.

The International ENERGY STAR® Office Equipment Program is an international program that promotes energy saving through the use of computers and other office equipment. The program backs the development and dissemination of products with functions that effectively reduce energy

consumption. It is an open system in which business proprietors can participate voluntarily. The targeted products are office equipment, such as computers, monitors, printers, fax, machine, copiers, and scanners. The standards and logos are uniform among participating nations.

This model doesn't provide "setting options" for power management.

European Union (and EEA) only.



This symbol indicates that this product is not to be disposed of with your household waste, according to the WEEE Directive (2002/96/EC) and your national law. This product should be handed over to a designated collection point, e.g., on an authorized one-for-one basis when you buy a new similar product or to an authorized collection site for recycling waste electrical and electronic equipment (WEEE). Improper handling of this type of waste could have a possible negative impact on the environment and human

health due to potentially hazardous substances that are generally associated with WEEE. At the same time, your cooperation in the correct disposal of this product will contribute to the effective usage of natural resources. For more information about where you can drop off your waste equipment for recycling, please contact your local city office, waste authority, approved WEEE scheme or your household waste disposal service. For more information regarding return and recycling of WEEE products, please visit www.canon-europe.com/environment.

(EEA: Norway, Iceland and Liechtenstein)

Für EMVG

Dieses Produkt ist zum Gebrauch im Wohnbereich, Geschäfts- und Gewerbebereich sowie in Kleinbetrieben vorgesehen.

Model Names

The following names may be provided for the safety regulations in each sales region of the Check Reader.

CR-L1: 6130110

CR-L1 UV: 6130120

Trademarks

- Canon and the Canon logo are registered trademarks, of Canon Inc. in the United States and may also be trademarks or registered trademarks in other countries.
- imageFORMULA is a trademark of CANON ELECTRONICS INC.
- Microsoft, Windows, Windows 7, Windows 8.1 and Windows 10 are registered trademarks or trademarks of Microsoft Corporation in the United States and other countries.
- Microsoft product screen shot(s) reprinted with permission from Microsoft Corporation.
- Adobe and Adobe Reader are registered trademarks or trademarks of Adobe Systems Incorporated in the United States and other countries.
- Other product and company names herein are, or may be, the trademarks of their respective owners.

Copyright

Copyright 2018 by CANON ELECTRONICS INC. All rights reserved.

No part of this publication may be reproduced or transmitted in any form or by any means, electronic or mechanical, including photocopying and recording, or by any information storage or retrieval system without the prior written permission of CANON ELECTRONICS INC.

Reproduction Warning

This device is designed to be used in a legal manner, in accordance with all applicable laws, including, but not limited to, counterfeit and copyright laws, as well as laws pertaining to national security.

Any person(s) found to have reproduced any of the following materials (regardless of whether such reproduction was intentional or not) for the purpose of misrepresenting such material as the original may be prosecuted in accordance with the applicable laws and regulations.

- Paper money or bank notes (domestic and foreign)
- Postage stamps, revenue stamps, or other similar stamps
- Stock certificates, bond certificates, promissory notes, cheques, or other valuable certificates
- Passports, licenses, or other certificates or documents issued by government officials or agencies

This is not an exhaustive list.

Canon is not responsible for how this scanner is used by an individual.

Please note that certain intellectual property is protected by copyright law, and copyrighted items may not be reproduced without the express permission of the copyright holder except for personal or household use under limited circumstances.

Disclaimers

The information in this document is subject to change without notice.

CANON ELECTRONICS INC. MAKES NO WARRANTY OF ANY KIND WITH REGARD TO THIS MATERIAL, EITHER EXPRESS OR IMPLIED, EXPECT AS PROVIDED HEREIN, INCLUDING WITHOUT LIMITATION, THEREOF, WARRANTIES AS TO MARKETABILITY, MERCHANTABILITY, FITNESS FOR A PARTICULAR PURPOSE OF USE OR NON-INFRINGEMENT. CANON ELECTRONICS INC. SHALL NOT BE LIABLE FOR ANY DIRECT, INCIDENTAL, OR CONSEQUENTIAL DAMAGES OF ANY NATURE, OR LOSSES OR EXPENSES RESULTING FROM THE USE OF THIS MATERIAL.

CANON ELECTRONICS INC. IS NOT LIABLE FOR THE STORAGE AND HANDLING OF DOCUMENTS SCANNED WITH THIS PRODUCT, OR THE STORAGE AND HANDLING OF THE RESULTING SCANNED IMAGE DATA. IF YOU INTEND TO DISCARD THE ORIGINALS OF THE SCANNED DOCUMENTS, YOU ARE RESPONSIBLE FOR INSPECTING THE SCANNED IMAGES AND VERIFYING THAT THE DATA IS INTACT. THE MAXIMUM LIABILITY OF CANON ELECTRONICS INC. UNDER THIS WARRANTY IS LIMITED TO THE PURCHASE PRICE OF THE PRODUCT COVERED BY THE WARRANTY.

Packaging: What Is in the Box?

Make sure that you have everything shown below. Check every item you have removed from the box. If any items are missing, contact your local authorized Canon dealer.

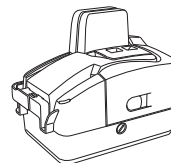

CR-L1



Disc

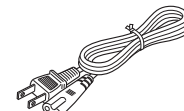

Power Cord^{*1}



**Marking Labels
for Thickness
Adjustment Dial**

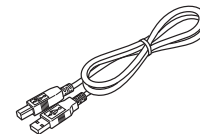

USB Cable



AC Adapter

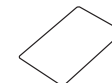

Warranty Card^{*2}

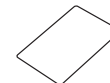

User Registration Card^{*2}



Setup & Operation Guide

^{*1} The power cord varies, according to the country of purchase.

^{*2} For the United States and Canada only.

NOTE

Items included in this package may change without any notice.

Preparation Before Use

This chapter describes how to prepare the scanner to scan documents.

Setting Up the Scanner

Perform the following steps to set up the CR-L1. Refer to the section for each step for details about that step.

- 1 Check your operating environment. (See “Checking Your Operating Environment,” on p. 5.)**



- 2 Install the software. (See “Installing the Software,” on p. 5.)**
Install the Scanning Utility provided with the CR-L1.



- 3 Connect the scanner to a computer. (See “Connecting the Scanner to a Computer,” on p. 6.)**



- 4 Turn ON the power. (See “Turning ON the Power,” on p. 7.)**



- 5 Automatically installing the device driver. (See p. 7.)**

The device driver is installed automatically when Windows recognizes the CR-L1.

! IMPORTANT

- To have the device drivers installed automatically when the computer recognizes the CR-L1, the software needs to be installed before the CR-L1 is connected to the computer.
- If you connect the computer and turn ON the CR-L1 before installing the software, the following wizard screen appears. If this happens, click [Cancel], turn OFF the CR-L1, and then install the software.

The following wizard screen is an example in Windows 7. When a similar wizard screen appears in Windows 8.1/10, click [Cancel].

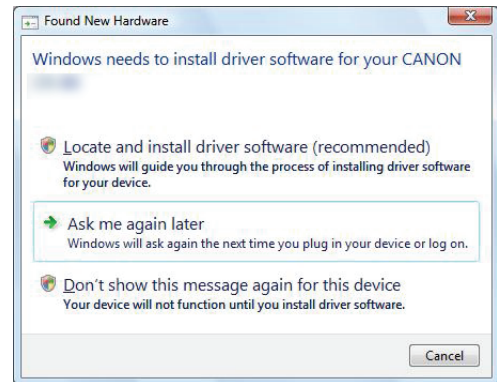

Wizard Screen (Windows 7)

Checking Your Operating Environment

The following computer system requirements are recommended for using the CR-L1.

Operating Systems:

- Microsoft Windows 7 (32/64bit) SP1 or later
- Microsoft Windows 8.1 (32/64bit)
- Microsoft Windows 10 (32/64bit)
- Microsoft Windows Server 2008 R2 Service Pack 1 or later
- Microsoft Windows Server 2012 R2
- Microsoft Windows Server 2016

This is the environment as of July 2018.

For the latest software support information, go to the Products page on the Canon website.

Specifications:

- CPU: Intel Core2 Duo 1.8 GHz or faster
- Memory: 1 GB or more
- USB 2.0 interface

Interface Cable

- Use the cable provided or a Hi-Speed USB 2.0 interface cable to connect to the computer's USB port.
- Scanning speed may vary depending on the specifications of your computer.

! IMPORTANT

- If you use the USB interface that was provided as standard with your computer:
 - Use the most recently available USB 2.0 driver provided by Microsoft. Contact your local authorized Canon dealer for more detailed information.
 - Not all USB interfaces provided as standard with personal computers are guaranteed. Contact your local authorized Canon dealer for more detailed information.
 - Scanning speeds are slower if your computer's standard USB interface is USB 1.1.
 - You should use the USB cable originally bundled with the scanner or a Hi-Speed USB 2.0 compatible cable.
- If the CPU, memory, interface card, and other specifications do not satisfy the installation requirements, the scanning speed may be greatly reduced and transmission may take longer.
- Even if the computer satisfies the recommended specifications, the scanning speed may vary, depending on the scan settings.

Installing the Software

The following software applications are provided on the website.

There are 2 usable software applications.

For the latest software support information, go to the Products page on the Canon website.

Canon Driver

The Canon Driver is the Canon original standard driver. You need this driver to use the Scanning Utility.

Scanning Utility

Canon Scanning Utility is an application that provides scanning, file saving, image viewing, printing, and various other functions. A dedicated scanner driver is installed after you install the utility software.

! IMPORTANT

- The Scanning Utility includes a device driver so that Windows can recognize the CR-L1. Be sure to install the Scanning Utility before connecting the CR-L1 to the computer.
- Some functions mentioned in this manual may not be operated in some applications.

Installing the Scanning Utility

Follow the instructions below to install the Scanning Utility and the dedicated driver.

NOTE

The dedicated scanner driver is installed after the Scanning Utility has been installed.

- 1 Turn ON your computer, and log on to Windows.

! IMPORTANT

Be sure to log on as the Administrator.

- 2 Download usable software from the Canon Website.

After executing the downloaded file, follow the instructions on the screen to complete the installation.

! IMPORTANT

- The displayed screen, type, file name, and folder name will differ depending on your environment or purpose. These items should be replaced as necessary.
- The computer may need to be restarted, after the installation, depending on the operating system. If this is necessary, make sure to restart the computer.

Connecting the Scanner to a Computer

The only way to connect the scanner to your computer is with a USB cable.

! IMPORTANT

- Be sure to use the USB cable bundled with the scanner or a Hi-Speed USB 2.0 compatible cable with the length less than 5 m.
- When the application is running, do not turn the scanner OFF or unplug the interface cable.
- Do not connect multiple CR-L1 scanners to one computer.

! CAUTION

- Do not turn OFF the scanner or remove the interface cable when an application is running.
- Turn OFF the computer and the scanner before changing the cable.

USB Connections

Connect the scanner and the computer with the cable provided or a Hi-Speed USB 2.0 cable.

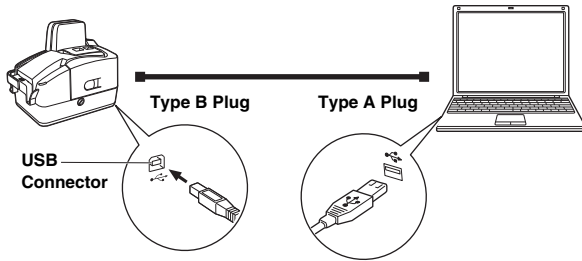

NOTE

Connect the type B plug (square) to the scanner and connect the type A plug (flat) to the USB port on the computer.

Connecting the Power Cord

Connect the power cord.

Make sure to use only the power cord provided with the scanner.

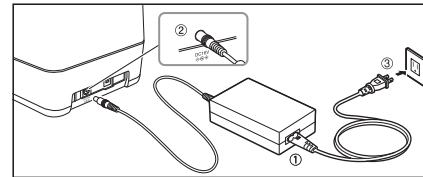
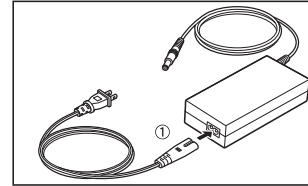

! WARNING

When connecting the power cord, follow these precautions. Failure to do so may cause a fire or electrical shock.

- Never grasp the power plug when your hands are wet.
- Never plug the scanner into a multiplug power strip.
- Never bundle or tie the power cord around itself or another object. Connect the power plug securely into the power outlet.
- Use only the power cord and power plug provided with the scanner.
- Before you connect the power cord, make sure to turn OFF the power switch.
- Connect only to a power outlet of the rated voltage and power supply frequency (either 120V, 60 Hz or 220-240V, 50/60 Hz, depending on your region).
- Do not plug the scanner into a power outlet shared with another device. If you use an extension cord, make sure that the extension cord is rated for the current requirements of the scanner.

Turning ON and OFF the Power

Follow the procedures below to turn the scanner power ON and OFF.

Turning ON the Power

- 1 To turn ON the scanner, slide the Power Switch to the right.

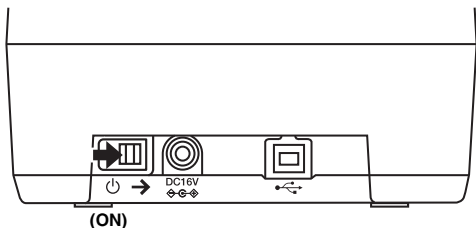

IMPORTANT

- When you turn ON the power, the power LED flashes slowly, and then turns solid.
- If the scanner does not work, there is a problem with the scanner. Turn OFF the power, and contact your local authorized Canon dealer or service representative to have the scanner serviced.

WARNING

If you hear strange sounds, detect smoke or abnormal heat, sense a vibration, or smell odd odors around the scanner, turn OFF the power immediately and disconnect the power cord from the power outlet. Contact your local authorized Canon dealer or service representative to have the scanner serviced.

- 2 Windows recognizes the CR-L1 as new hardware, and installation starts automatically.



(Windows 7)

NOTE

The CR-L1 will be registered as "CANON CR-L1 USB" in the Imaging Device directory.

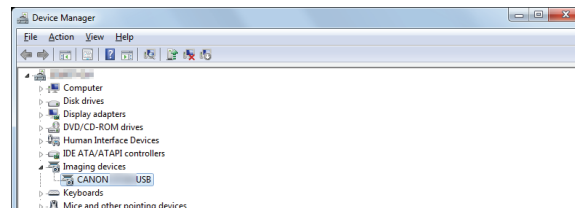

Turning OFF the Power

- 1 Turn OFF your computer.
- 2 To turn OFF the scanner, slide the Power Switch to the right.

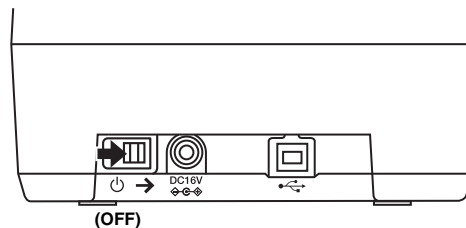

CAUTION

- Wait at least 10 seconds before turning the scanner back ON.
- For your safety, disconnect the power plug from the power outlet if you are not using the scanner for a long period of time.

NOTE

The scanner's auto power off setting is enabled by default, and the scanner will turn off automatically if it is not operated for 4 hours. For details on how to disable this setting, see "Auto Power Off," on p. 27

INTRODUCTION

Thank you for purchasing the Canon Check Reader CR-L1. Please read this manual thoroughly before using the machine in order to familiarize yourself with its capabilities, and to make the most of its many functions. Unless otherwise noted, CR-L1 is used for both the CR-L1 and the CR-L1 UV models, throughout this manual.

Manuals for the CR-L1

The following manuals are provided with the CR-L1. Be sure to read these manuals thoroughly before using the scanner. (The Setup & Operation Guide extracted from the User Manual.) Electronic manual is stored as a PDF file on the supplied Setup Disc and requires Adobe Reader to open. (You can download Adobe Reader from the Adobe Web site.)

Setup & Operation Guide (Supplied with the scanner/Electronic Manual)

Describes the procedure for setting up the CR-L1 for scanning. Set up the CR-L1 in accordance with the Setup & Operation Guide. For details on the CR-L1, refer to the User Manual (electronic manual).

User Manual (Electronic Manual): This Manual

Describes how to use the scanner, and includes instructions for configuring the scanner settings, as well as handling, maintenance, and troubleshooting information.

Symbols Used in This Manual

The following symbols are used in this manual to explain procedures, restrictions, handling precautions, and instructions that should be observed for safety.

WARNING

Indicates a warning concerning operations that may lead to death or injury to persons if not performed correctly. To use the machine safely, always pay attention to these warnings.

CAUTION

Indicates a caution concerning operations that may lead to injury to persons, or damage to property if not performed correctly. To use the machine safely, always pay attention to these cautions.

IMPORTANT

Indicates operational requirements and restrictions. Be sure to read these items carefully to operate the machine correctly, and avoid damaging the machine.

NOTE

Indicates a clarification of an operation, or contains additional explanations for a procedure. Reading these notes is highly recommended.

Table of Contents

Packaging: What Is in the Box?	3	Long Document Mode	25
Preparation Before Use	4	Auto Power Off	27
Setting Up the Scanner	4	Troubleshooting	28
Checking Your Operating Environment	5	When the Scanner Is Not Recognized	28
Installing the Software	5	Clearing Paper Jams	28
Installing the Scanning Utility	5	The Scanner Does Not Turn ON	30
Connecting the Scanner to a Computer	6	Feeding Trouble	30
USB Connections	6	When the Scanned Image Is Not Normal	31
Connecting the Power Cord	6	Maintenance	32
Turning ON and OFF the Power	7	Daily Cleaning	32
Turning ON the Power	7	Cleaning the Main Unit	32
Turning OFF the Power	7	Cleaning the Inside of the Scanner	32
INTRODUCTION	8	Cleaning the Scanning Glass and Rollers	32
Manuals for the CR-L1	8	Cleaning the Magnetic Heads	34
Symbols Used in This Manual	8	Cleaning the Ink Jet Nozzles	34
Important Safety Instructions	10	Cleaning with the Cleaning Cards (United States Only)	35
Handling	10	Maintenance	37
Disposal	10	Replacing the Ink Cartridge	37
Installation Location	11	Adjusting the Separation Roller Gap	40
Power Supply	11	Specifications	42
Moving the Scanner	11	Scanner Specifications	42
Introduction to the CR-L1	12	AC Adapter Specifications	42
Features of the CR-L1	12	Index	43
Features	12		
Part Names	13		
Front View	13		
Rear View	15		
Connectors/Power Switch	15		
Exterior Dimensions	15		
Preparing the Ink Cartridge	16		
About the Ink Cartridge	16		
Setting the Ink Cartridge and Adjusting the Print Position	16		
Software	19		
How to Use the Software	19		
How to Use the Scanning Utility	19		
Uninstalling the Software	20		
Document Feeding and Scanning	22		
Documents	22		
Document	22		
Using Infrared Double Feed Detection	23		
Placing Documents	23		
Document Feeding and Scanning	23		
Scan Procedure	23		
Confirming Proper Document Feeding	24		

Important Safety Instructions

Handling

WARNING

- Never install and operate the scanner near flammable substances, such as alcohol, paint thinner, benzene, or any other type of volatile solution.
- Never damage or modify the power cord, and never place heavy objects on the power cord.
- Always make sure that your hands are dry when you are handling the power cord or power plug. Never grasp the power plug when your hands are wet.
- Never plug the scanner into a multiplug power strip.
- Never bundle, wrap, or tie the power cord around itself or another object. Connect the power plug securely into the power outlet.
- Use only the power cord and power plug provided with the scanner.
- Never attempt to disassemble or modify the scanner.
- Never use flammable aerosol products near the scanner.
- Before you clean the scanner, turn the power OFF and disconnect the power cord from the power outlet.
- To clean the scanner's exterior, use a firmly wrung cloth, moistened slightly with water or mild detergent. Never use any type of volatile solution, such as alcohol, benzene or paint thinner.
- If you hear strange sounds, detect smoke or abnormal heat, sense vibration, or smell odd odors around the scanner, turn OFF the power switch immediately and disconnect the power cord from the power outlet. Contact your local authorized Canon dealer or service representative to have the scanner serviced.
- Handle the scanner with care. Avoid shock and vibration to the scanner caused by reckless handling. If you suspect the scanner has been accidentally damaged, turn OFF the power switch immediately and disconnect the power cord from the power outlet. Contact your local authorized Canon dealer or service representative to have the scanner serviced.
- Before you move the scanner, always turn OFF the power and disconnect the power cord from the power outlet.
- This product emits low level magnetic flux. If you use a cardiac pacemaker and feel abnormalities, please be away from this product and consult your doctor.

CAUTION

- To avoid damage to the scanner, never place the scanner on an unstable or vibrating surface. The scanner may tip or fall over, causing injury.
- Keep all liquids, beverages, or any type of liquid, and clips, staples, necklaces, or other metal objects away from the scanner. If you accidentally spill liquid or drop a metal object into the scanner, turn OFF the power immediately and disconnect the power cord from the power outlet. Contact your local authorized Canon dealer or service representative to have the scanner serviced.
- Never install the scanner in humid or dusty locations. Doing so may cause a fire or electrical shock.
- Never place heavy objects on top of the scanner, as these objects may tip or fall over, and cause injury.
- When you remove the power cord, grip it by the power plug head. Never attempt to disconnect the power cord from the power outlet by pulling on the power cord. Doing so may damage or expose the cord's internal wiring, and cause a fire or electrical shock.
- Keep the area around the power outlet clear of all obstacles so you can disconnect the power cord easily at all times.
- Never spill water or volatile solutions (alcohol, benzene, paint thinner) into the scanner. Doing so may cause a fire or electrical shock.
- When the scanner is not being used for a long period of time, disconnect the power cord from the power outlet.
- Avoid wearing loose fitting clothing, dangling jewelry, long ties, or long hair that could become entangled with moving parts, especially the rollers that feed paper into the scanner. If such objects become entangled, immediately disconnect the power plug from the power outlet to stop the scanner.
- Be careful when you are loading a document or clearing a paper jam. It is possible that the paper edges may cut your fingers.
- Do not open the Maintenance Cover while the scanner is operating. Doing so may result in a malfunction or injury.
- Do not touch the pins and contacts on the scanner's connector with your hands. Doing so may result in a malfunction.

Disposal

When disposing of this scanner, be sure to follow all local ordinances and laws or consult with the retailer who sold you the scanner.

Installation Location

For operation, maintenance, and ventilation, make sure that there is enough space around the scanner.

Avoid placing the scanner in the following places. It may cause a malfunction and adversely affect the scanner or your computer.

- Places exposed to direct sunlight
If installation in such places is unavoidable, provide a curtain or similar object to shade the scanner.
 - Places subject to dust and fumes
Dust and cigarette fumes adversely affect the components inside the scanner.
 - Near running water, a heat source, water vapor, or in an area, such as a laboratory exposed to ammonia gas, paint thinner, or other volatile chemicals
 - Places subject to excessive vibration and shock
 - Places subject to rapid changes in temperature or humidity
Condensation occurring inside the scanner may impair image quality. Place the scanner in a room that is within the following range:
Room temperature: 10°C to 32.5°C (50°F to 90.5°F)
Relative humidity: 20% to 80% RH
20% to 50% RH when using the imprinter
- Use the recommended operating environment for the ink cartridge when using the imprinter.
- Near electronic equipment or heavy equipment that generates a strong magnetic field, such as a speaker, TV, and radio

Power Supply

- Connect only to a power outlet of the rated voltage and power supply frequency (either 120V, 60 Hz or 220-240V, 50/60 Hz, depending on your region).
- Make sure that the scanner is connected to an independent power outlet. Do not plug the scanner into an outlet shared with another device. If you use an extension cord, make sure that the extension cord is rated for the current requirements of the scanner.
- If you are unsure of anything relating to the power supply, contact your local authorized Canon dealer or service representative for further information.
- Never place an object on top of the power cord or step on the power cord.
- Never bundle the power cord or wrap the cord around an object, such as a table leg.
- Do not tug on the power cord. When you remove the power cord, grip it by the power plug head.
- Keep the area around the power outlet free of obstacles.
- Connect only to a power outlet of the rated voltage and power supply frequency (either 120V, 60 Hz or 220-240V, 50/60 Hz, depending on your region).
- Do not connect to power outlets with other electrical devices. Also, when using an extension cord, make sure that the extension cord is rated for the current requirements of the scanner.

- Disassembling and/or reassembling the AC adapter is extremely dangerous and should not be attempted under any circumstances.
- Do not place heavy objects on the AC adapter or power cord. Do not place the adapter or cords in an area where they are likely to be stepped on.
- Do not use the power cord while it is bundled.
- Never pull directly on the power cord. To remove the plug from the outlet, grasp the plug directly and remove it from the outlet.
- Keep the area around the power plug clear of articles so that the power plug can be disconnected in an emergency.
- Use only the AC adapter provided with the product. Do not use the scanner's AC adapter with any other product.
- If you have any questions about the AC adapter, contact your local authorized Canon dealer or service representative for further information.

Moving the Scanner

When you move the CR-L1, hold it firmly with both hands and carry it carefully. Do not hold the scanner by the Eject Stopper. The scanner weighs approximately 2.1 kg (4.6 lb).

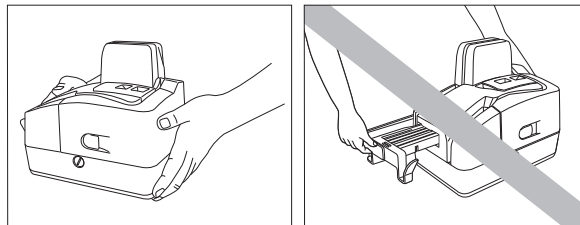

WARNING

When moving the scanner, be sure to turn OFF the power and remove any cables. If the cables are not removed before moving the scanner, you may damage the plugs or connector by forcibly pulling them out.

Introduction to the CR-L1

This chapter describes the features of the CR-L1 scanner, what comes packaged in the box, and the names and functions of parts on the scanner.

Features of the CR-L1

The Canon Check Reader CR-L1 is a scanner with magnetic heads that can read checks and other documents that are printed with MICR (Magnetic Ink Character Recognition) compatible fonts, and is capable of OCR (Optical Character Recognition).

Features

Fast and Smooth Scanning

The CR-L1 performs high-speed scans of check-size documents at 45 cpm (200 dpi resolution).

Supports Long Documents

Documents up to 108 mm x 2,000 mm (4.3" x 78.7") can be scanned.

Compact Size

140 mm (W) x 223 mm (D) x 188 mm (H) (5.5" (W) x 8.8" (D) x 7.4" (H))

Supports Color, Black-and-White (Binary) and Grayscale Output

Reads MICR Characters

A magnetic head is used to scan MICR characters that have been printed with magnetic ink or toner.

Supports OCR (Optical Character Recognition)

Character images, such as E13B, OCR-A, OCR-B, and check writer are recognized as characters by the OCR function.

Supports UV scanning (UV model only)

CR-L1 UV can scan images that are printed with UV fluorescent ink. This function only scans the front side of documents.

Easy to Maintain

Maintenance Covers make handling paper jams and cleaning easy.

Paper Thickness Adjustment Mechanism

Adjust the Separation Roller gap to the thickness of the paper being fed.

Infrared Double Feed Detection

The scanner detects double-fed documents using infrared sensor.

Imprinter Is Standard Equipment

An imprinter mechanism, which prints text on documents as they are scanned, comes standard equipped with the scanner. The imprinter's ink cartridge is not included, and must be purchased separately. (See "About the Ink Cartridge," on p. 16.)

Part Names

This section describes the names and functions of each part. Before you connect the CR-L1, familiarize yourself with its parts and their functions.

Front View

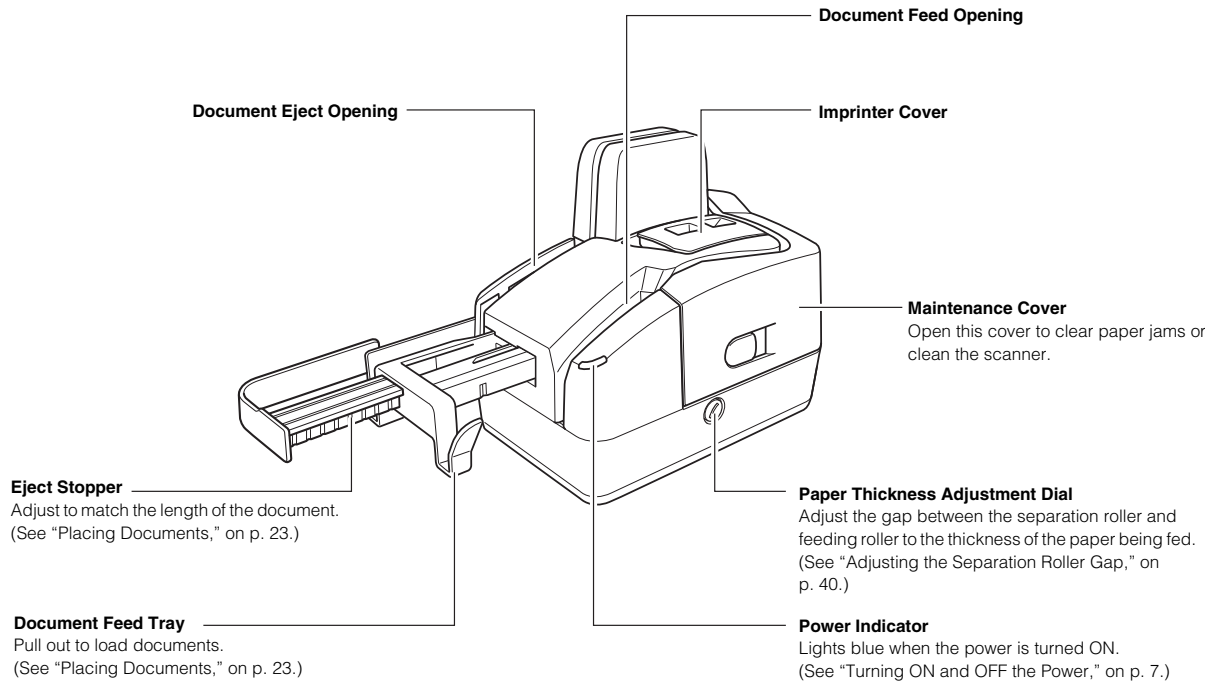

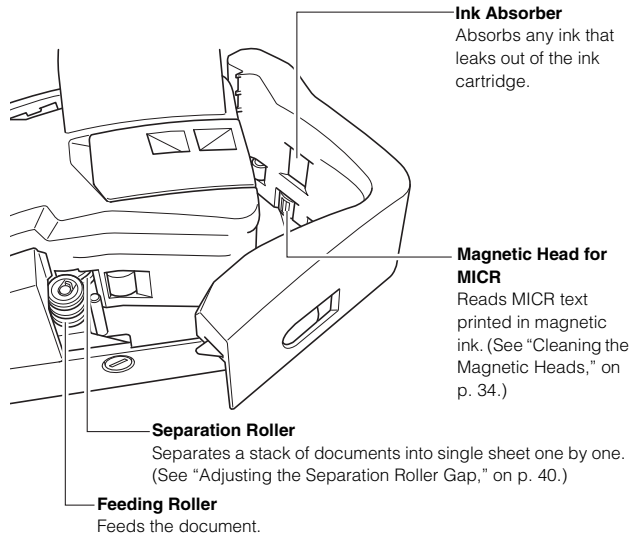
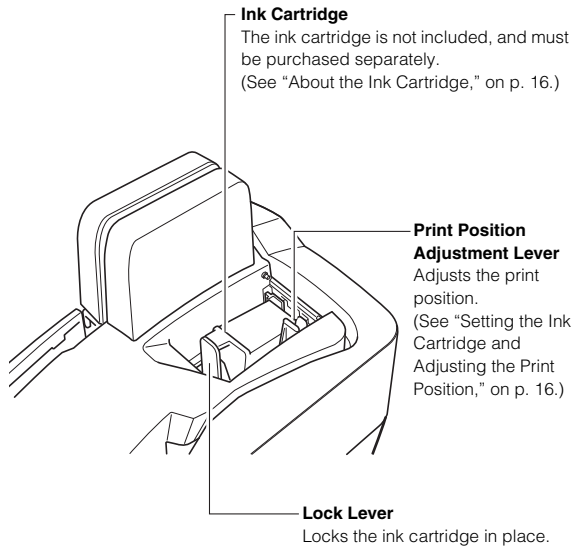

Rear View

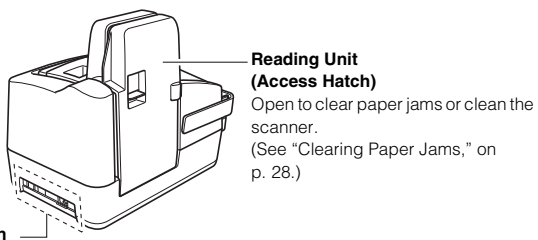

Connectors/Power Switch

Power Switch

Slide to turn the scanner power ON.
Slide again to turn the scanner power OFF.
(See "Turning ON and OFF the Power," on p. 7.)

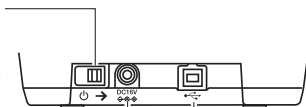

Connect the included AC adapter plug.
(See "Connecting the Power Cord," on p. 6.)

USB Connector

Connect a Hi-Speed USB 2.0 compliant USB cable. (See "USB Connections," on p. 6.)

Exterior Dimensions

Units: millimeters (units in parenthesis are inches)

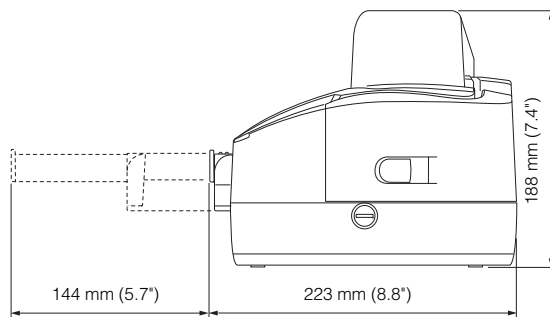
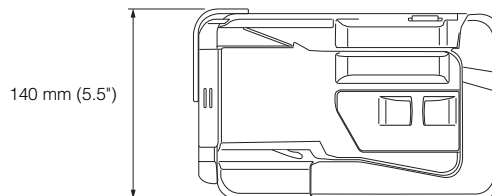

Preparing the Ink Cartridge

This section describes how to prepare the ink cartridge so that you can use the imprinter to print text on scanned documents.

About the Ink Cartridge

The ink cartridge is not included with the scanner. Purchase an ink cartridge separately, as shown below.

Manufacturer : Hewlett Packard

Ink Cartridge Blue : C6602B (Canon#3693A002)

Ink Cartridge Red : C6602R (Canon#3693A003)

Ink Cartridge Green: C6602G (Canon#3693A004)

Setting the Ink Cartridge and Adjusting the Print Position

The ink cartridge needs to be set to print. Set the ink cartridge according to the following procedure. You can adjust the print position to three different levels.

! IMPORTANT

- To set the ink cartridge, turn the scanner OFF before removing the Maintenance Cover. After the ink cartridge is set, replace the Maintenance Cover, and then turn the scanner back ON.
- Finish up the unpacked ink cartridge as soon as possible. More frequent cleaning of the ink cartridge is required if long time elapses after unpacking.

- 1** Hook your finger around the open lever and open the Maintenance Cover.

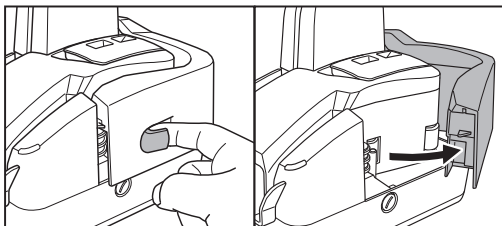

- 2** Remove the Imprinter Cover.

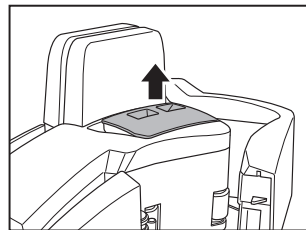

- 3** Remove the ink cartridge from its bag.

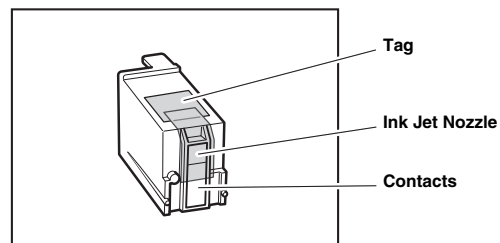

! IMPORTANT

Do not touch the ink cartridge contacts. This can cause a bad electrical contact and reduced print quality.

- 4** Grasp the tag and then peel off the tape covering the ink jet nozzle.

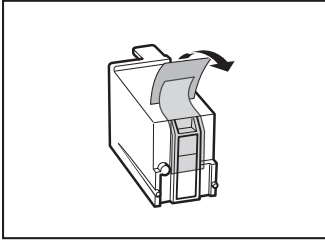

! IMPORTANT

Do not touch the ink jet nozzle or contacts after peeling off the tag and tape.

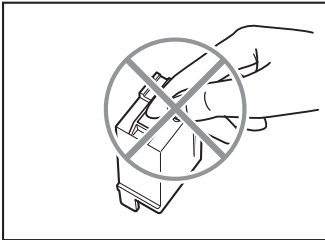

- 5** Place the ink cartridge shown in the diagram below.

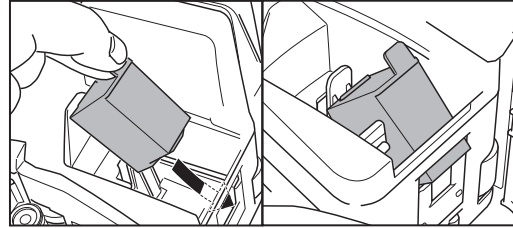

! CAUTION

Do not touch the electrical contact on the carriage. Doing so may cause a malfunction.

NOTE

Do not use more than one cartridge by rotation. If you do so, applications cannot check the ink level precisely.

- 6** Push down the ink cartridge until it clicks into place.

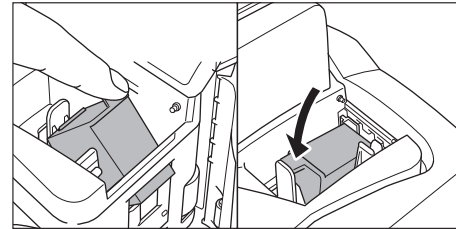

! IMPORTANT

Make sure that the ink cartridge lock lever locks the ink cartridge into the correct position.

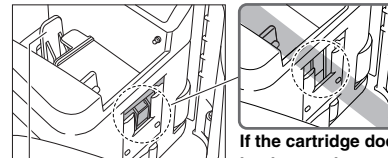

Ink Cartridge Lock Lever

If the cartridge does not load properly, see step 7.

- 7** Squeeze the Print Position Adjustment Lever and move it to adjust the print position.

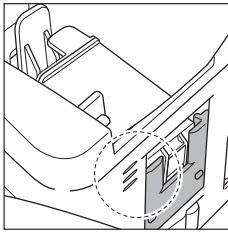

Top:
50.5 mm (1.99") from the bottom edge of the document

Middle:
47 mm (1.85") from the bottom edge of the document

Bottom:
43.5 mm (1.71") from the bottom edge of the document

If the ink head drops back when installed, the two ink cartridge pins will not fit into the holes on the carriage. Push back the ink cartridge lock lever ① in the direction of the arrow and reset the cartridge in the correct position ②.

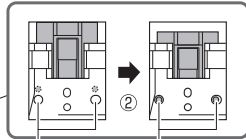
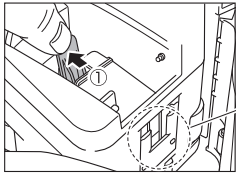

Ink Cartridge Holes **Ink Cartridge Pins**

- 8** Carefully replace the Imprinter Cover.

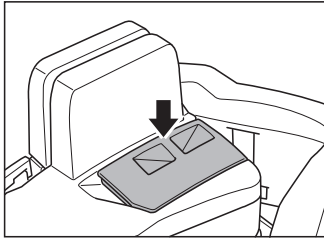

- 9** Gently close the Maintenance Cover until it clicks into place.

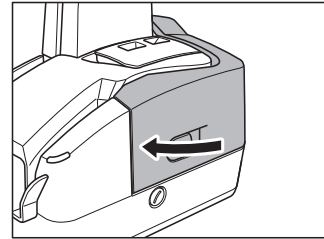

Software

This chapter describes how to use the Scanning Utility.

How to Use the Software

This section describes how to start up the Scanning Utility so that you can use the scanner. Read the Help files for the Scanning Utility for information on how to use it.

How to Use the Scanning Utility

This section describes the procedure for using the Scanning Utility. Read the [Help] file in [Scanning Utility] for more information.

- 1 Click [Start], and then click [All Programs].

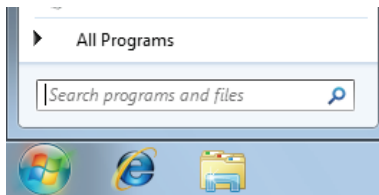

- 2 Click [Scanning Utility for CR-50&80&L1].

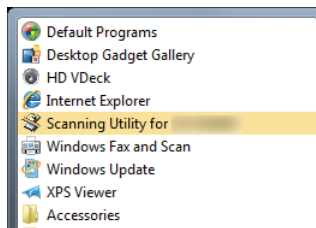

- 3 Start the Scanning Utility.

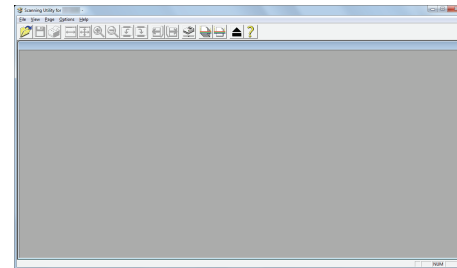

NOTE

The basic operation of the Scanning Utility is noted in the Scanning Utility help file. On the [Help] menu, click [Help] to view the explanation.

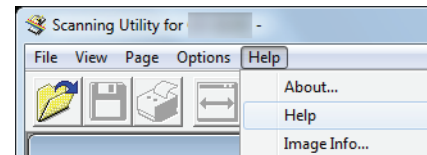

- 4 Select [Scanner Setting] from the [File] menu.

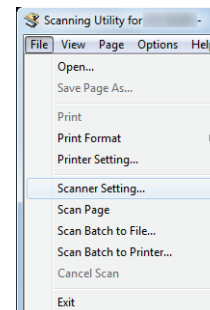

The Settings dialog box appears.

- 5 Set the scan conditions and click [OK].

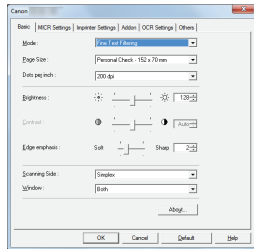

NOTE

For information about the settings for the scan conditions, click [Help] on the Settings dialog box to open the Help file.

- 6 Select the scanning method from the [File] menu and start scanning.

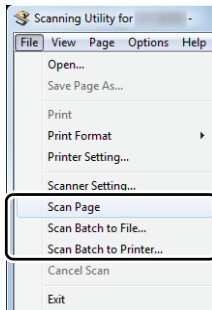

- 7 When scanning is finished, click [Exit] on the [File] menu to quit the Scanning Utility.

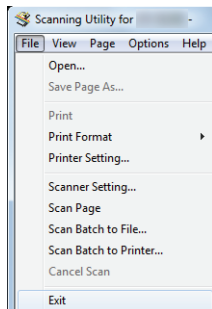

Uninstalling the Software

This section describes how to uninstall the Scanning Utility.

! IMPORTANT

- Be sure to log on as the Administrator.
- The procedure in Windows 8.1/10 is different from the ones described in this manual. Refer to the Windows 8.1/10 "Help and Support Center" to uninstall the software.

- 1 Click [Start], and then click [Control Panel].

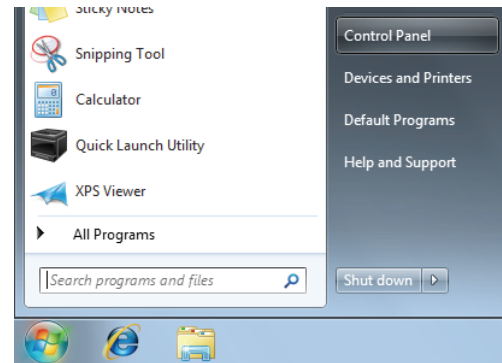

2 Click [Programs], and then click [Programs and Features].

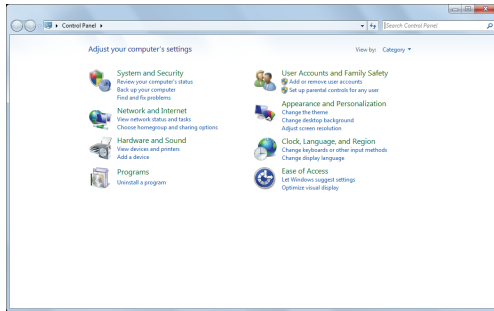

3 Select the software that you want to remove from the list in the dialog box, and then click [Uninstall].

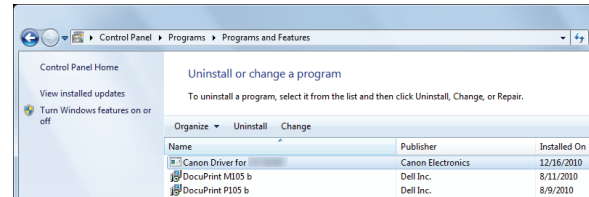

NOTE

When the [User Account Control] dialog box appears, click [Continue].

NOTE

Depending on the status of your computer, the following screen may be displayed. In that case, double-click the [Programs and Features] icon.

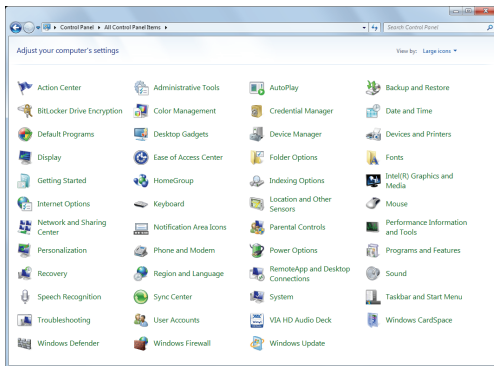

IMPORTANT

If you uninstall "Scanning Utility for CR-50/80/L1 (or CR-50&80&L1)" you also need to uninstall "Canon Driver for CR-50/ 80/ L1 (or CR-50&80&L1)."

4 The [Confirm File Deletion] dialog box appears.

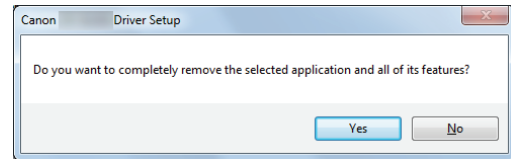

If you selected "Canon Driver for CR-50/ 80/ L1 (or CR-50&80&L1)", the above dialog box appears.

5 Click [Yes], and the uninstaller starts.

Follow the instructions on the screen to finish uninstalling the software.

Document Feeding and Scanning

This chapter describes precautions regarding documents that can be handled on this scanner and scanning operations.

Documents

This section describes the types of documents that can be used and how to place them.

CAUTION

Treat the documents carefully. The paper edges may cut your fingers.

Document

The CR-L1 can feed a wide variety of document sizes. The ranges of height and length for a document are:

Height : 50 to 108 mm (2.0" to 4.3")

Length : 95 to 228 mm (3.7" to 9.0")

up to 2,000 mm (78.7") with Long Document mode

Thickness : 0.08 to 0.20 mm (0.003" to 0.008")

Weight : 64 to 157 g/m² (17 to 40 lb bond)

81 to 105 g/m² (21.5 to 26.8 lb bond) with Double Feed Detection enabled

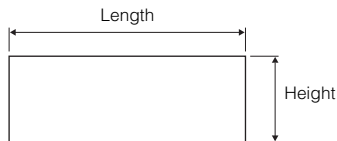

NOTE

Depending on the paper type and paper thickness, false detection of double feed may occur.

Follow these guidelines when you prepare a document for scanning:

- Before scanning documents that contain pasted artwork, make sure that the ink or paste is thoroughly dry. If the documents are scanned with wet ink or paste, the inside of the scanner may become dirty and it may cause a malfunction.
- If you scan a document written in pencil, the letters may not be scanned properly or the pencil may rub off onto the rollers and stain subsequent documents. Before you scan this kind of document, make a copy, and then scan the copy. After scanning a document written in pencil or some other soft writing material, be sure to clean the scanning rollers. (See "Cleaning the Scanning Glass and Rollers," on p. 32.)
- If you scan thin paper in the Duplex mode, the ink printed on the back side may be scanned. If this happens, adjust the scanning density.

- Scanning documents with a rough surface may not feed easily, and may cause friction between the documents, resulting in a feeding error. If this happens, feed the documents one by one.
- To avoid paper jams, damage to documents, and a scanner malfunction, do not feed the following types of paper into the scanner. If you want to scan these types of paper, first make a copy, and then scan the copy.



Wrinkled or creased paper



Carbon backed paper



Curled paper



Coated paper or fax recording paper



Torn paper



Extremely thin paper



Paper with clips or staples



Paper with binding holes

NOTE

- Note that mixing documents of different thickness may cause a malfunction during feeding.
- Curled, wrinkled, or folded documents may cause an error. If this happens, straighten out the curls, or reduce the number of documents loaded.

Using Infrared Double Feed Detection

The double feed detection function that the scanner is equipped with uses the infrared sensor to detect when two or more documents are fed at the same time. If false detections happen too often, disable the double feed detection function.

NOTE

- When Using the Accompanying Scanning Utility for CR-50/80/L1 (or CR-50&80&L1):
You can disable the double feed detection function from [Scanner Setting] in the Scanning Utility.
- For more details about how to configure scanning parameters, click the [Help] button in the settings dialog box to view the Canon driver help.

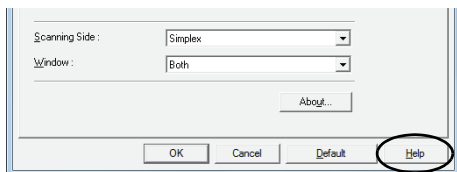

IMPORTANT

- The following types of document may be misdetected as double fed:
 - Documents with a colored background
 - Documents with a glossy finish
- If misdetection of double feeds occurs often, turn off double feed detection.

Placing Documents

Note the following points when placing documents on the scanner.

- Place the front of the document toward you.
- A maximum of 50 documents (90g/m² (24 lb bond)) or a document stack no higher than 5 mm (0.2") can be loaded at one time (including curling).
- Move the stopper to the edge of the document in the document tray in accordance with the document. Otherwise, this may cause a paper eject error.
- When scanning multiple documents, sort them into batches of uniform paper quality and thickness and load each batch separately. Note that loading mixed batches may cause paper jams.
- When scanning relatively thick (0.15 mm to 0.2 mm (0.005" to 0.008")) documents, the feeding process may cause the document to curl and cause paper jams at the document feed opening. For such documents, load no more than 10 sheets at one time.

IMPORTANT

Align the documents and set the bottom of the documents level in the document tray.

Document Feeding and Scanning

This section describes how to load and scan documents.

CAUTION

- Avoid wearing loose fitting clothing, dangling jewelry, long ties, or long hair that could become entangled with moving parts, especially the rollers that feed paper through the scanner. If such objects become entangled, immediately disconnect the power plug from the power outlet.
- Check the paper stack and remove all clips, staples, pins, or any other type of metal or plastic fastener. These objects may cause damage to the document, a paper jam, or a scanner malfunction.
- Do not touch documents that are being fed under any circumstances. The documents that are being fed may cut your hand.

Scan Procedure

- 1 Pull out the document feed tray.

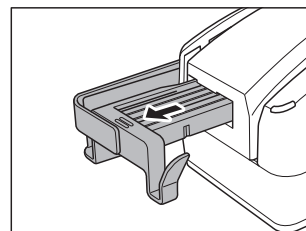

- 2 Carefully align the edges of the document.
- 3 Load the documents with their front sides facing right and with their edges flush against the document load mark.

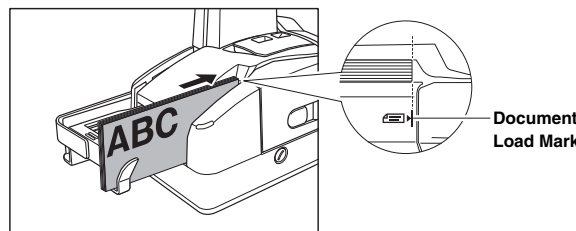

- 4 Adjust the Eject Stopper in accordance with the document.

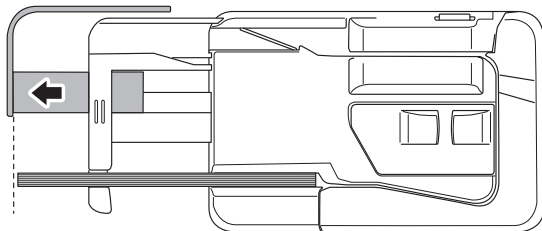

- 5 Instruct scanning to start from the software application.

 **NOTE**

- When Using the Accompanying Scanning Utility for CR-50/80/L1 (or CR-50&80&L1):
There are three scanning methods as follows. Follow the each instruction.

Scan 1 page

Click [Scan Page] from the [File] menu.

Scan Batch to File

- ① Click [Scan Batch to File] from the [File] menu.
- ② Input the File name, and then click [Save].
- ③ Select Simplex or Duplex, and then click [Start Scanning].

Scan Batch to Printer

- ① Click [Scan Batch to Printer] from the [File] menu.
- ② Select Simplex or Duplex, and then click [Start Scanning].

- 6 Scanning starts.

 **NOTE**

When printing with the imprinter, ink may get on the leading edge of the document because the documents are ejected onto the printed surface.

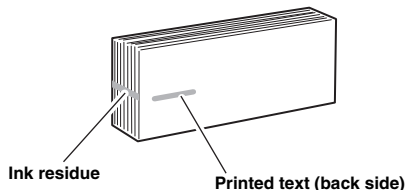

Confirming Proper Document Feeding

Depending on the thickness of documents scanned with the CR-L1 and the paper thickness setting, double feeds or feeding errors may occur. After installing the CR-L1 or before scanning documents of a different thickness, perform the procedure below to confirm that documents are separated one sheet at a time. If documents do not feed properly, see "Adjusting the Separation Roller Gap," on p. 40 to adjust for paper thickness.

- 1 Start the Scanning Utility.

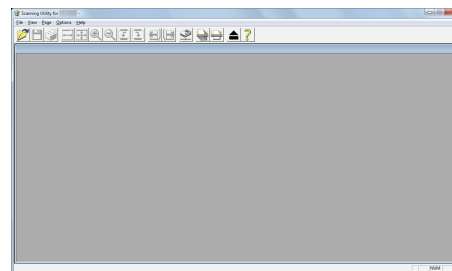

 **NOTE**

For instructions on using the scanning utility, see "How to Use the Scanning Utility," on p. 19. You can also refer to the scanning utility help in the [Help] menu.

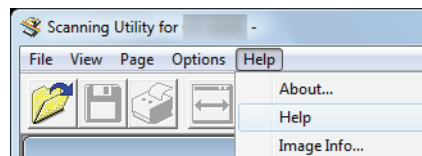

- 2 Pull out the document feed tray.

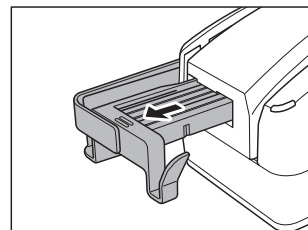

- 3** Load two documents with their edges flush against the mark.

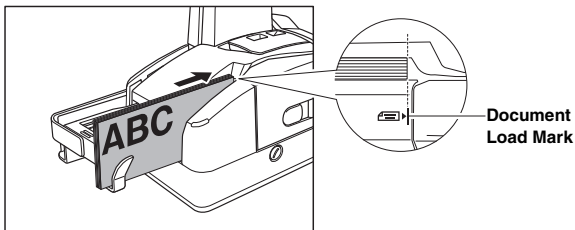

- 4** Adjust the position of the eject stopper. (If necessary, see the diagram in step 4 on p. 24.)

- 5** Click [Scan Page] from the [File] menu and confirm that only one sheet is fed.

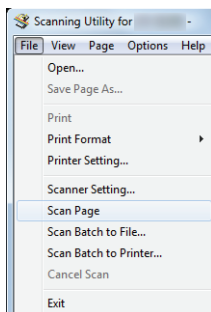

NOTE

If the sheets do not feed properly (they double-feed or no sheets are fed), see "Adjusting the Separation Roller Gap," on p. 40 to adjust for paper thickness.

- 6** Exit the scanning utility.

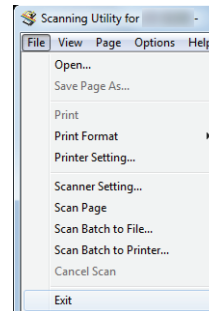

Long Document Mode

You can scan documents up to 2,000 mm (78.7") in length with the Long Document mode.

CAUTION

Be careful not to cut your finger with the edge of the document.

IMPORTANT

Note the following points when using the Long Document mode.

- Detach the Eject Stopper when feeding long documents.
- When feeding long documents, if a document is loaded into the scanner askew, it may catch on the edge of the feeder and suffer damage. Make sure to take extra care that documents are loaded straight in this mode.
- In the Long Document mode, documents may suffer damage because paper jam detection is delayed. Make sure to take extra care against paper jams in this mode.
- Processing speed may decrease when scanning with the Long Document mode.

- 1** Start the Scanning Utility. ("How to Use the Scanning Utility" on p. 19.)

- 2** Click [Scanner Setting] from the [File] menu.
The scanner driver's Detail Settings screen will open.

IMPORTANT

When the scanner settings screen is opened by the application, the below screen is displayed, in which advanced scanning conditions can be specified.

NOTE

For details on the setting screen, see the Help of the scanner driver.

Click the [Help] button of the driver to display help related to the corresponding tab or dialog box.

- 3** Set the [Page Size] in the [Basic] tab to [Auto detection] when scanning in the Long Document mode.

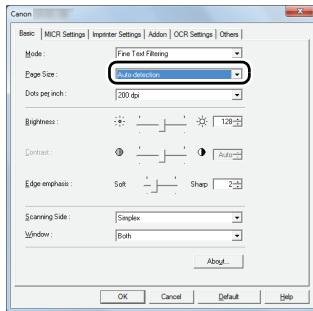

- 4** Then, set the [Long Document mode] value in the [Others] tab. You can scan documents up to 2,000 mm (78.7") long by setting the scanner to the Long Document mode. Select [Standard] or [2000mm] depending on the length of the document.

- 5** Click [OK] to close the scanner driver settings screen.

- 6** Pull out the document feed tray.

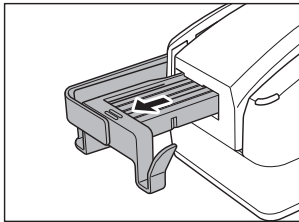

- 7** Pull out the Eject Stopper.

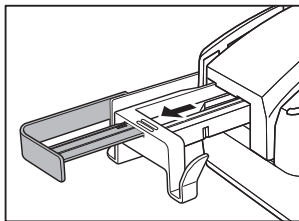

- 8** Pinch the Eject Stopper and slide it to detach.

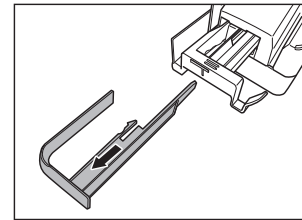
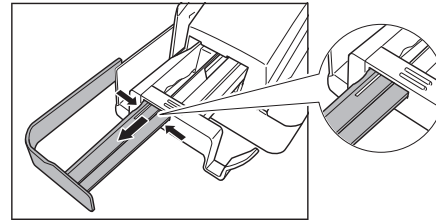

- 9** Load the document.

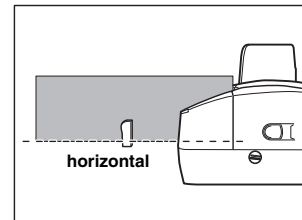

! CAUTION

- When scanning long documents whose length are more than 228 mm (9.0"), place one document at a time. Otherwise, it may damage the documents.
- When feeding the document, support it to keep the same height between the document and the feed path. If the document is lower than the feed path, the document may be torn. If the document is higher than the feed path, the scanned image may be skewed.
- The lower edge of a thin long document may be damaged with feeding. Do not feed the document fed many times or torn documents.

10 Instruct scanning to start from the software application.

! IMPORTANT

- Set the [Page Size] to [Auto detection] when scanning in the Long Document mode.

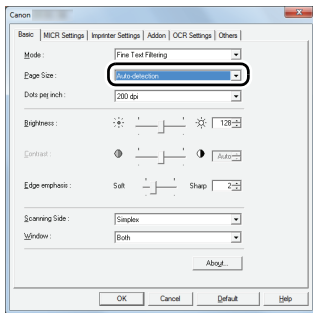

- The document length that can be scanned in the Long Document mode depends on the scan mode and resolution.

Mode	DPI	Maximum Length
Black and White Error Diffusion Fine Text Filtering 16-level Gray 256-level Gray	100	2,000 mm (78.7")
	120	
	200	
	300	
24-bit Color	100	2,000 mm (78.7")
	120	
	200	
24-bit Color	300	1,000 mm (39.4")

11 Scanning starts.

12 When scanning is finished, push the Eject Stopper into the document feed tray to attach.

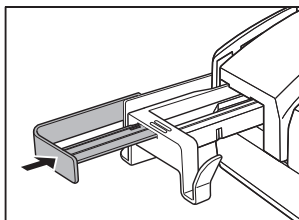

Auto Power Off

The scanner automatically turns off when scanning or another operation is not performed for a certain time.

To setting this function, follow the procedure below.

- 1** Start Windows and log in as a user with administrator privileges.
- 2** Click the Start button, and then click [All Programs], [CANON CR-L1], and [Canon imageFORMULA Utility]. imageFORMULA Utility starts.
- 3** Click [CANON CR-L1 USB] and click [Properties]. Scanner properties are displayed.
- 4** Click the [Maintenance] tab and then click [Turn off automatically after 4 hours] check box to change the setting.

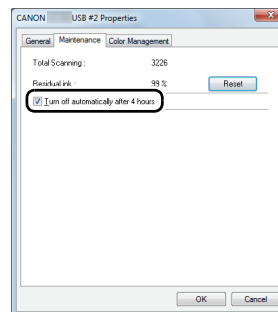

5 Click [OK] to close the scanner properties.

Troubleshooting

This chapter describes the problems that might occur in the CR-L1, and how to remedy them.

When the Scanner Is Not Recognized

The following causes and remedies describe why your computer may not recognize the scanner.

Cause The Scanning Utility is not installed.

Remedy Install the Scanning Utility before connecting the scanner to the computer. (See "Setting Up the Scanner," on p. 4.)

Cause The scanner is not correctly connected to the computer.

Remedy Connect the scanner to the computer correctly. (See "Connecting the Scanner to a Computer," on p. 6.)

Cause The USB interface provided as standard with your computer is not compatible with the scanner.

Remedy Not all USB interfaces provided as standard with personal computers are guaranteed. Contact your local authorized Canon dealer for more detailed information. (See "Checking Your Operating Environment," on p. 5.)

Cause USB cable is not compatible with the scanner.

Remedy Use the USB cable provided with the scanner. (See "Checking Your Operating Environment," on p. 5.)

Cause USB hub is not compatible with the scanner.

Remedy Remove the USB hub to use the scanner. (See "Checking Your Operating Environment," on p. 5.)

Clearing Paper Jams

If paper has jammed, open the Maintenance Cover and remove the jammed paper.

! IMPORTANT

Do not attempt to pull the jammed paper upwards or backwards against the feeding direction. Doing so can damage the internal parts of the scanner.

! CAUTION

- Be careful when you clear a paper jam. You may be injured unexpectedly. For example, the paper edges may cut your fingers, or the document may be damaged.
- Remove all jammed sheets of paper. Paper scraps left inside the scanner may cause a paper jam or malfunction.

- 1 Hook your finger around the open lever and open the Maintenance Cover.

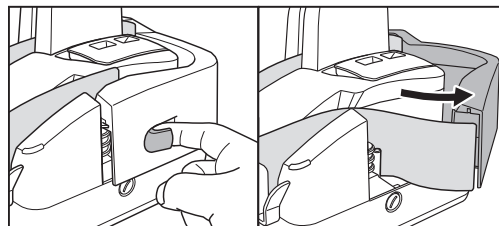

- 2 While lowering the down the OPEN lever, open the reading unit.

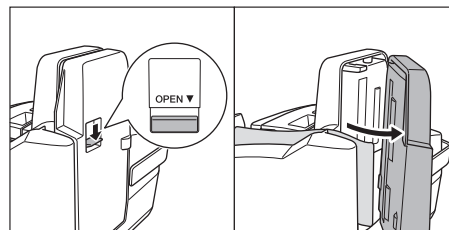

3 Remove the paper that has jammed.

If the paper is jammed at the pickup area: Pull the paper forward and clear the jam from the Maintenance Cover.

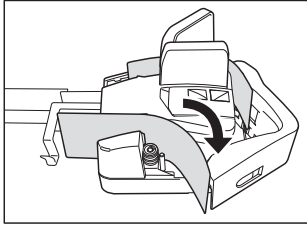

If the paper is jammed at any other area: Pull the paper forward and clear the jam from the nearest opening.

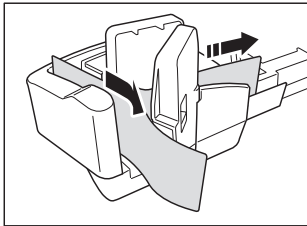

4 Gently close the reading unit until it clicks into place.

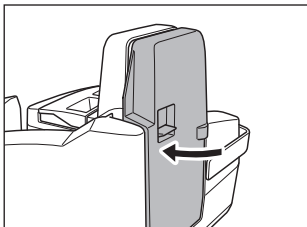

5 Gently close the Maintenance Cover until it clicks into place.

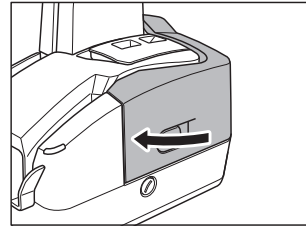

The Scanner Does Not Turn ON

Check the following conditions, and take the appropriate action.

The power indicator is not lit.

Slide the Power Switch to the right. (See "Turning ON the Power," on p. 7.)

The power cord is not connected into a power outlet.

Connect the power cord into a power outlet. (See "Connecting the Power Cord," on p. 6.)

Feeding Trouble

If the document is not fed properly or the detection functions do not work properly, remedy the problem by checking the following conditions.

Condition **A paper jam has occurred.**

Cause and Remedy

- Check to make sure that the size and thickness of the document are within the supported range of the scanner, and if the quality of the paper is appropriate. For cautions on handling documents, see "Documents," on p. 22.
- Documents with rough surfaces may cause a paper feed error to occur.
- Dirty or worn rollers inside the scanner may cause a paper jam. Clean the rollers if they are dirty. (See "Cleaning the Scanning Glass and Rollers," on p. 32.) Worn rollers must be replaced. Contact your local authorized Canon dealer or service representative to have the scanner serviced.
- The Separation Roller gap is too wide. Adjust the Separation Roller gap. (See "Adjusting the Separation Roller Gap," on p. 40.)

Condition **A double feed error often occurs.**

Cause and Remedy

A double feed error may occur when documents with different thicknesses are mixed. If the above-mentioned method is not effective or you are using the CR-L1 scanner, adjust the Separation Roller gap. (See "Adjusting the Separation Roller Gap," on p. 40.)

Condition **MICR characters are not recognized correctly.**

Cause and Remedy

- The scanner cannot correctly read MICR characters if the magnetic heads are dirty. Clean the MICR magnetic heads. (See "Cleaning the Magnetic Heads," on p. 34.)
- If MICR characters cannot be recognized correctly after cleaning the heads, the MICR heads may be worn. Contact your local authorized Canon dealer or service representative to have the scanner serviced.
- The MICR text is on the back of the document. Load the side with the MICR characters face up in the document tray.
- Some of the MICR characters are scratched or missing. Splattered MICR ink or toner may also be the problem.

Other Causes

Condition **The imprinter is not printing correctly (missing imprint dots).**

Cause and Remedy

Ink is clogged in the ink jet nozzle. Clean the ink jet nozzle. Cleaning the ink jet nozzle is recommended before using the CR-L1. (See "Cleaning the Ink Jet Nozzles," on p. 34.)

Other Causes The ink cartridge may be empty.

Condition **Documents get dirty when using the imprinter.**

Cause and Remedy Ink from the imprinter has been placed on the feed path. Clean the ink off the feed path. (See "Cleaning the Ink Jet Nozzles," on p. 34 and "Cleaning the Inside of the Scanner" on p. 32.)

When the Scanned Image Is Not Normal

If there is a problem with the scanned image (the image is not sharp or stripes appear), one of the following conditions may be a probable cause. Check the following conditions, and take the appropriate action.

The scanning glass or rollers are dirty.

If the scanning glass or rollers are dirty, the dirt will appear on the scanned image.

▶ Clean the scanning glass and rollers. For details, see "Cleaning the Scanning Glass and Rollers," on p. 32.

The scan conditions are inappropriate.

If the scan conditions are inappropriate, the scanned image will not be sharp or will appear as dark.

▶ Check the brightness and other scanner settings.

If the scanned image is blurry or the document has not been scanned at all, the brightness may be set too high.

If the scanned image appears dark, the brightness may be set too low.

Also, check the settings on the driver and the software application.

▶ Check the basic Scanning Conditions. (UV models only)

If other than [16-level Gray] or [256-level Gray] is selected for Mode menu in the scanner driver, the scanned image may not be appropriate.

Also, check the settings on the driver and the software application.

The driver or application does not run correctly.

If the document cannot be scanned correctly even if the scan conditions are adjusted, the driver or the application may not be functioning correctly.

▶ Reinstall the driver or application.

For details on how to install the driver, see "Installing the Software," on p. 5.

For details on how to install the application, see the applications instruction manual.

Other Causes

Even if the computer may be recognizing the scanner correctly, and the driver and the application is installed correctly, scanning may not be performed correctly. If this happens, the interface card is not compatible. Use the recommended interface card.

If the above remedies do not rectify the problem, contact your local authorized Canon dealer or service representative to have the scanner serviced.

Maintenance

This chapter describes how to clean and maintain the scanner.

Daily Cleaning

To ensure high-quality image scanning, regularly clean your CR-L1 as described below.

⚠ CAUTION

- Before you clean the scanner, turn OFF the scanner and computer, and disconnect the power cord from the power outlet. Otherwise, it may cause an electrical shock.
- Never clean the scanner with any kind of organic solvent, such as alcohol, benzene, or paint thinner. This may cause a fire and electrical shock, or cause the exterior of the scanner to disfigure or discolor.
- Never spray mild detergent or water directly on the scanning glass. The spray could penetrate below the glass and contaminate the internal light source and lenses.

Cleaning the Main Unit

Wipe the scanner with a firmly wrung cloth, moistened slightly with water or mild detergent. Then, wipe off with a clean, dry cloth.

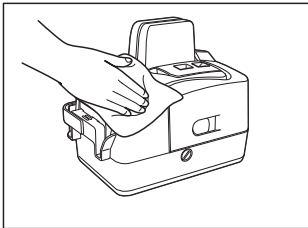

Cleaning the Inside of the Scanner

Dust or paper particles inside the scanner can cause lines in scanned images. Use compressed air for regular cleaning of dust and paper particles from inside the scanner. After finishing a large scanning job, you should turn OFF the scanner and then clean off any paper particles that are remaining.

Cleaning the Scanning Glass and Rollers

If stripes appear on scanned images or if dirt appears on scanned documents, clean the scanning glass and rollers. Clean the scanning glass and rollers regularly.

- 1 Hook your finger around the open lever and open the Maintenance Cover.

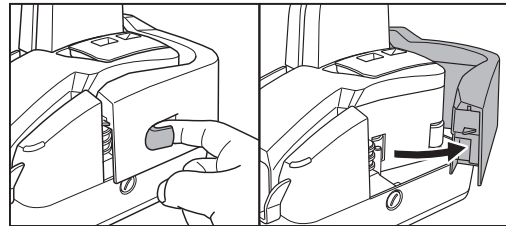

- 2 While lowering the open lever, open the reading unit.

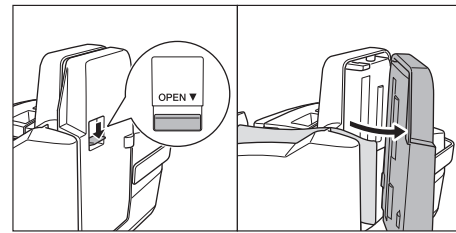

⚠ WARNING

Do not use flammable liquids to clean the scanner, including alcohol, benzene, or paint thinner.

- 3** Spin the rollers while wiping them clean with a firmly wrung cloth dampened with water or a mild detergent.

There are 18 roller positions, as shown in the diagram below.

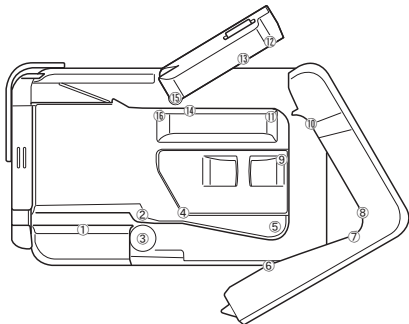

NOTE

- Use cotton swabs to clean the rollers in locations that are too narrow for your fingers, such as ①, ②, ⑩, ⑭, ⑮, and ⑯.
- Rollers in positions ②, ④, ⑤, ⑩, and ⑯ are turned by the roller in position ⑤. Turn the roller in position ⑤ to wipe the rollers.
- Rollers in positions ⑬ and ⑭ comprise two rollers each, an upper roller and a lower roller.
- Do not force the rollers if they will not turn. In this case, wipe dirt only off of the exposed area.

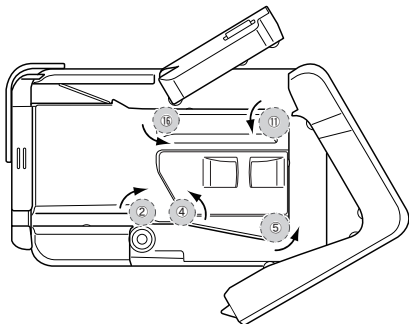

- 4** Use cotton swabs to clean the entire scanning glass. There are two scanning glass areas, one on each side. Use a cotton swab to wipe dirt from the entire surface of each.

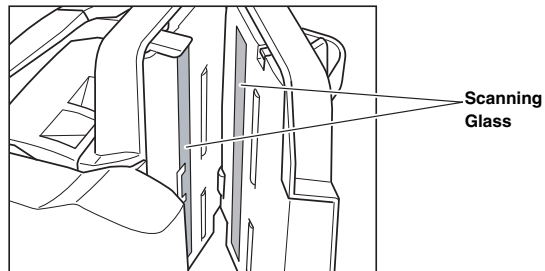

! IMPORTANT

Scratches on the scanning glass may cause marks on the images and could cause feeding errors. If there are scratches on the scanning glass, contact your local authorized Canon dealer or service representative.

- 5** Gently close the reading unit until it clicks into place.

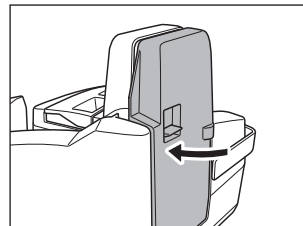

- 6** Gently close the maintenance cover until it clicks into place.

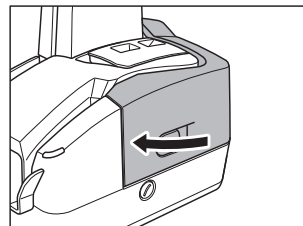

Cleaning the Magnetic Heads

If the magnetic heads are dirty, then MICR characters cannot be scanned correctly. Periodically, clean the magnetic heads with a commercially available audio head cleaner.

- 1 Hook your finger around the open lever and open the maintenance cover.

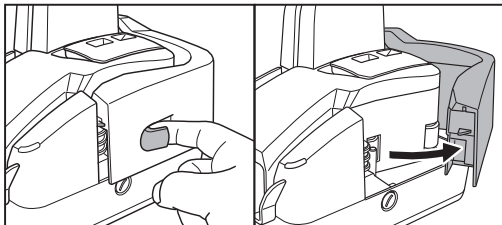

- 2 Use a commercially available audio head cleaner to clean the magnetic heads.
The magnetic head is located in the position shown in the diagram below.

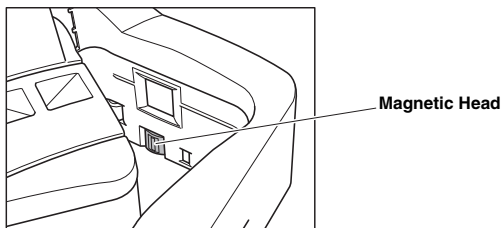

- 3 Gently close the maintenance cover until it clicks into place.

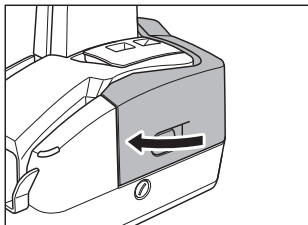

Cleaning the Ink Jet Nozzles

Ink that collects around the ink jet nozzles may stain your documents or cause the text to appear as scratched. Clean the area around the ink jet nozzles periodically. Cleaning the ink jet nozzles is also efficient action when the printed text becomes faint.

- 1 Hook your finger around the open lever and open the Maintenance Cover.

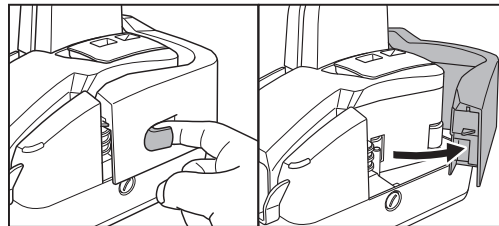

- 2 Dampen a cloth with water, wring the cloth out thoroughly, and then wipe off the dirt around the ink absorber.

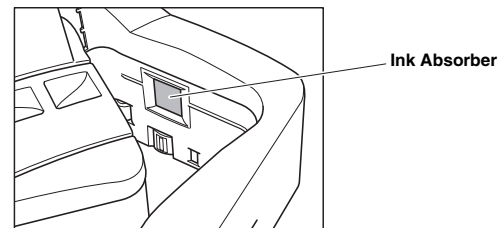

! IMPORTANT

If your documents are stained and smudged from printing even after you clean the ink absorber, you should replace the ink absorber. Contact your local authorized Canon dealer or service representative.

- 3 Remove the ink cartridge.
For more information, (See "Replacing the Ink Cartridge," on p. 37.)

- 4** Use a dry cotton swab to wipe off any ink on the ink jet nozzle.
If the text still appear faint after this operation, replace the ink cartridge
(See "Replacing the Ink Cartridge," on p. 37.)

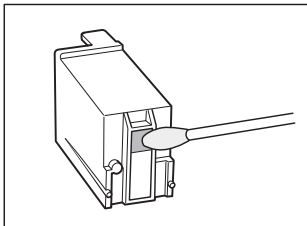

- 5** Set the ink cartridge.
For more information, see "Setting the Ink Cartridge and Adjusting the Print Position," on p. 16.

- 6** Carefully replace the Imprinter Cover.

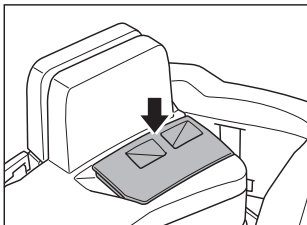

- 7** Gently close the Maintenance Cover until it clicks into place.

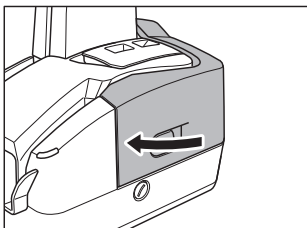

Cleaning with the Cleaning Cards (United States Only)

If a black stripe appears on the back-side of scanned images or if dirt appears on the paper documents upon scanning or for preventative measures, we recommend that you clean your Canon CR-Series scanner as needed with a cleaning card. Using a cleaning card will minimize the frequent cleaning as instructed in this manual. It is best to perform a cleaning at beginning or end of the day. A cleaning card does not clean the ink jet nozzles, so please remove the ink cartridge and perform a nozzle cleaning (See "Cleaning the Ink Jet Nozzles," on p. 34)

! IMPORTANT

- This operation is for the Cleaning cards that are available only in the United States.
- Contact your local authorized Canon dealer or service representative for the available cleaning card.

- 1** You may download the Canon Check Scanner Cleaning Tool from the Canon U.S.A. website at the following URL:
<http://www.usa.canon.com/checktransports>

- 2** Pull the Eject Stopper.

- 3** Place the cleaning card (for Check Path Cleaning) in the document tray.

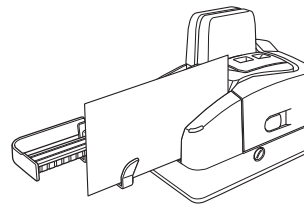

- 4** Locate where you saved the file From step 1 , extract it and double-click the CleanCR.exe file shown below.

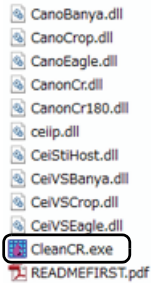

- 5** From the drop-down menu, please select CR-50/ 80/ L1 and click [OK].

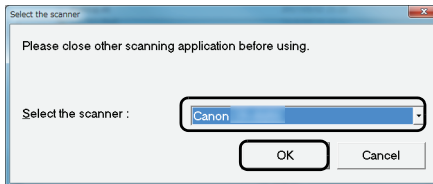

- 6** With the Cleaning Card already in the feed pocket of the scanner, please click Clean.

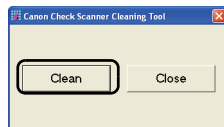

- 7** The Cleaning Card will then proceed through the paper path as shown below.

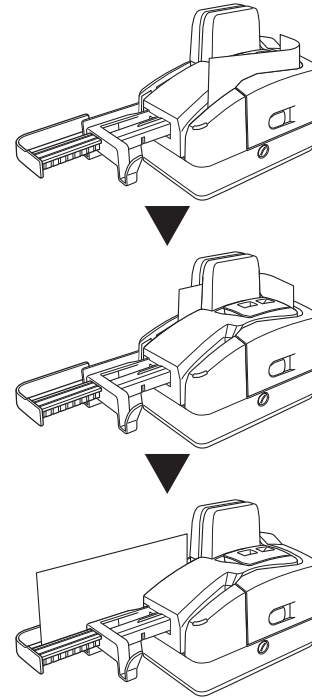

- 8** Please repeat steps 3 and 6.
A typical cleaning consists of feeding the Cleaning Card 3-7 times. Each time you run the card through, invert and/or flip it in the feed pocket. If the scanner is extremely dirty, you may need to use another Cleaning Card.

- 9 When you have finished cleaning your scanner, please click on the Close button to exit out of the Canon Check Scanner Cleaning Tool.

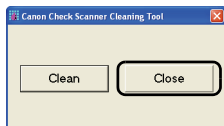

 **NOTE**

Upon completion, please allow 1 to 2 minutes for the moisture on the Canon CR-Series scanner from the Cleaning Card to thoroughly dry before scanning documents.

Maintenance

Make the following adjustments to maintain scanning quality.

Replacing the Ink Cartridge

The ink cartridge needs to be replaced if the printed text becomes scratchy or faint even if you have cleaned the ink jet nozzle. Replace the ink cartridge according to the following procedure below.

 **IMPORTANT**

- To replace the ink cartridge, turn the scanner OFF before removing the Maintenance Cover. After the ink cartridge is set, replace the Maintenance Cover, and then turn the scanner back ON.
- Finish up the unpacked ink cartridge as soon as possible. More frequent cleaning of the ink cartridge is required if long time elapses after unpacking.

 **NOTE**

- Use an ink cartridge. (See "About the Ink Cartridge," on p. 16.)
- Do not use more than one cartridge by rotation. If you do so, applications cannot check the ink level precisely.

- 1 Hook your finger around the open lever and open the Maintenance Cover.

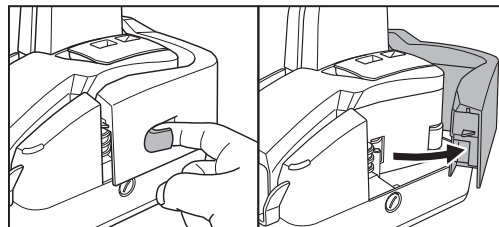

- 2 Remove the Imprinter Cover.

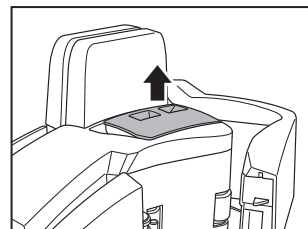

- 3** Squeeze in both sides of the print position adjustment lever and move the print cartridge carriage to its lowest position.

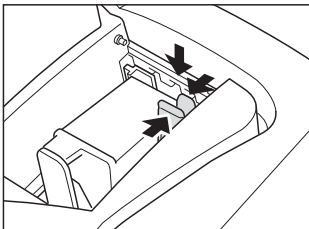

- 4** Push back the ink cartridge lock lever in the direction of the arrow in the diagram below, and pull out the ink cartridge by grasping the tab as shown in the diagram.

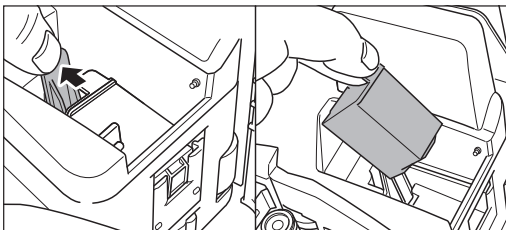

CAUTION

Do not touch the ink jet nozzle right after imprinting. The nozzle may be very hot.

- 5** Place the ink cartridge shown in the diagram below.

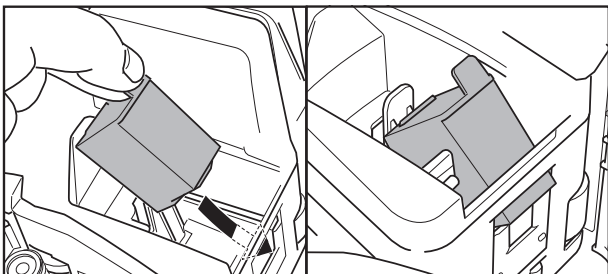

CAUTION

Do not touch the electrical contact on the carriage. Doing so may cause a malfunction.

NOTE

Do not use more than one cartridge by rotation. If you do so, applications cannot check the ink level precisely.

- 6** Push down the ink cartridge until it clicks into place.

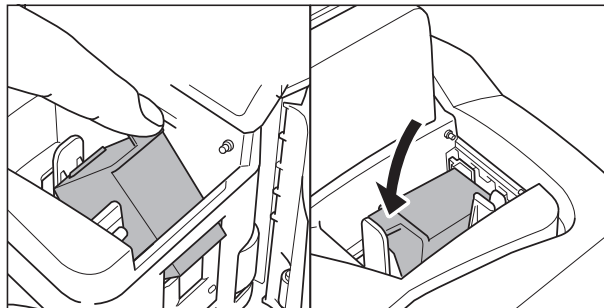

IMPORTANT

Make sure that the ink cartridge lock lever locks the ink cartridge into the correct position.

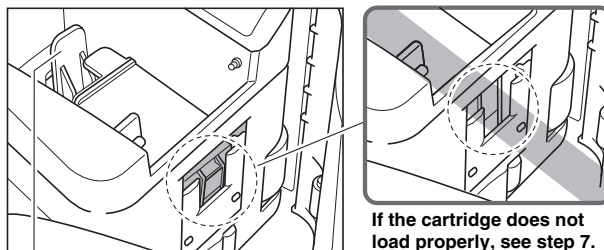

Ink Cartridge
Lock Lever

If the cartridge does not load properly, see step 7.

- 7** Squeeze the Print Position Adjustment Lever and move it to adjust the print position.

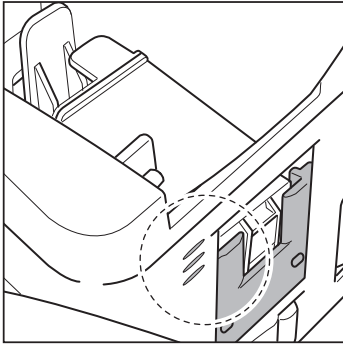

Top:

50.5 mm (1.99") from the bottom edge of the document

Middle:

47 mm (1.85") from the bottom edge of the document

Bottom:

43.5 mm (1.71") from the bottom edge of the document

If the ink head drops back when installed, the two ink cartridge pins will not fit into the holes on the carriage. Push back the ink cartridge lock lever ① in the direction of the arrow and reset the cartridge in the correct position ②.

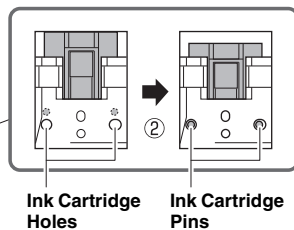
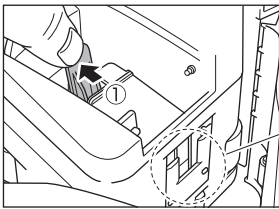

- 8** Set the ink cartridge.

For more information, see "Setting the Ink Cartridge and Adjusting the Print Position," on p. 16.

- 9** Carefully replace the Imprinter Cover.

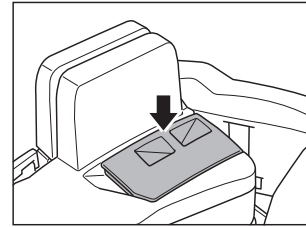

- 10** Gently close the Maintenance Cover until it clicks into place.

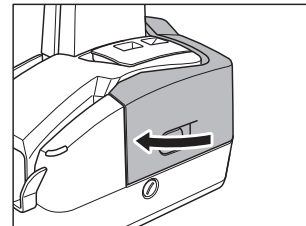

- 11** Start Windows and log in as a user with administrator privileges.
- 12** Click the Start button, and then click [All Programs], [CANON CR-L1], and [Canon imageFORMULA Utility].
imageFORMULA Utility starts.
- 13** Click [CANON CR-L1 USB] and click [Properties].
Scanner properties are displayed.
- 14** Click the [Maintenance] tab and then click [Reset].

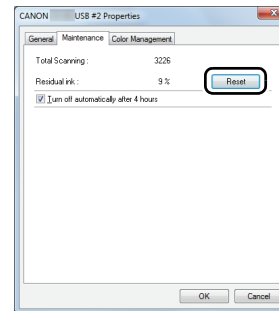

- 15 Click [OK] to close the scanner properties.

NOTE

You can reset the Residual ink from the Scanning Utility. Click [About], and then click [Reset] on the setting dialog box. (See Step 5 on p. 20)

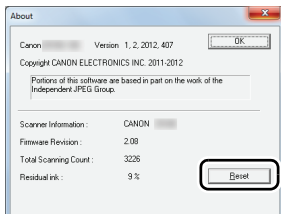

Adjusting the Separation Roller Gap

If double feed should occur too often, adjust the Separation Roller gap according to the following procedure.

IMPORTANT

- Make sure that the size, thickness, and weight of your document meets the conditions of this scanner. See "Document," on p. 22.
- Your unit has been carefully adjusted to meet most conditions. However, the below adjustment may be needed depending on your environment (humidity, temperature, etc.) and the documents you are scanning (checks, etc.). Perform the adjustment only if necessary.

- 1 Hook your finger around the open lever and open the Maintenance Cover.

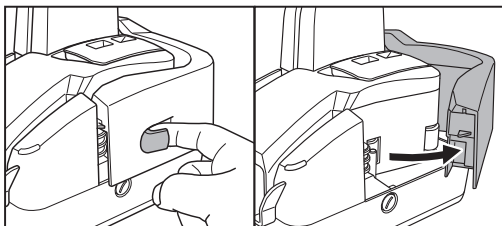

- 2 Pull out the document feed tray.

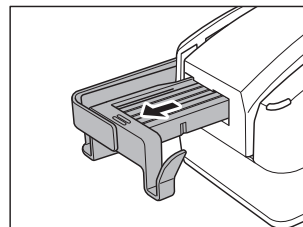

- 3 Load two checks or check-stock paper together.

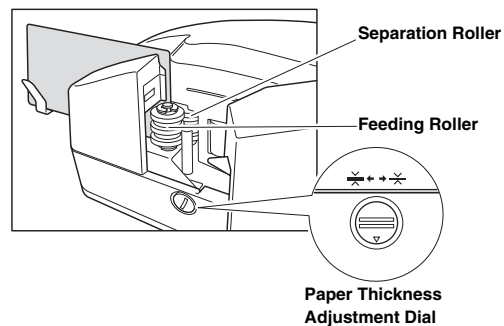

- 4 Slide the two sheets through between the feeding roller and the separation roller and stop at the position shown below.

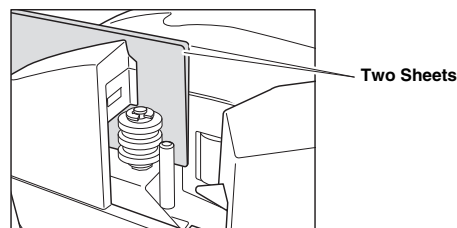

NOTE

If you were unable to slide both sheets through the gap between the rollers, turn the paper thickness adjustment dial counter-clockwise (left) until both sheets two pieces easily slide through the gap.

- 5 Gently remove one of the sheets.

- 6** Adjust the gap between the feeding roller and the separation roller to optimum width.

While one sheet remains in place between the rollers, continuously attempt to slide the second sheet (in front of the remaining sheet) to the right, back through the roller gap.

Slowly turn the paper thickness adjustment dial clockwise (right) just until the second sheet stops feeding into the gap.

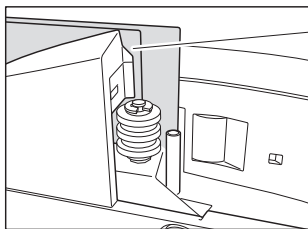

Second sheet does not feed into the gap.

! IMPORTANT

Turning the Adjustment Dial clockwise too much may damage the rollers.

- 7** Remove the sheets from the paper path and close the Maintenance Cover.

- 8** Confirm that the document feeds properly.

See "Confirming Proper Document Feeding," on p. 24.

If additional assistance is required, contact your local authorized Canon dealer or service representative.

- 9** Place a marking label on the unit pointing to the adjustment dial as illustrated below. This will serve as a reference point for future adjustments if required.



Marking labels for thickness adjustment dial

Specifications

Scanner Specifications

Type	Desktop sheet-through scanner
Document size	Height: 50 to 108 mm (2.0" to 4.3") Length: 95 to 2,000 mm (3.7" to 78.7") Thickness: 0.08 to 0.20 mm (0.003" to 0.008") Weight: 64 to 157 g/m ² (17 to 40 lb bond)
Document feeding	Automatic
Scanning method	Contact image sensor (CMOS)
Light source	LED (CR-L1 UV: UV LED)
Scanning side	Simplex/Duplex
Scanning mode	Black-and-white, Fine Text Filtering, Error diffusion, 16-Level gray, 256-Level gray, 24-bit color, UV Scan
Scanning resolution (primary scan lines x secondary scan lines)	100 x 100 dpi, 120 x 120 dpi, 200 x 200 dpi, 300 x 300 dpi
Scanning speed (American checks)	CR-L1: 45 cpm CR-L1 UV: 45 cpm (UV Scan mode)
Automatic feeder capacity	Load limit of less than 5 mm (0.2") (within the load limit mark)
Automatic document feed capacity	Up to 50 sheets (90 g/m ² (24 lb bond)) Make sure stacks do not exceed 5 mm in height (including curling)
Interface	Hi-Speed USB 2.0
Other functions	Infrared double feed detection
Dimensions	140 mm (W) x 223 mm (D) x 188 mm (H) (5.5" (W) x 8.8" (D) x 7.4" (H))
Weight	Approximately 2.1 kg (4.6 lb)
Power requirement	DC16V 0.8A (excluding AC adapter)

Power consumption

		Scanning	Sleep mode	Power SW OFF
CR-L1	120V 220-240V	15.8W or less	2.3W or less	0.1W
CR-L1 UV	120V 220-240V	15.8W or less	2.3W or less	0.1W

AC Adapter Specifications

Model number	MG1-5042
Input	AC 100-240V 50/60Hz 0.57-0.32 A
Output	DC16V 1.6A
Weight	Approximately 0.2 kg (0.44 lb) (excluding power cord)

- Use the recommended operating environment for the ink cartridge when using the imprinter.
- You can use the functions noted above if your software supports them.
- These functions may not work depending on your computer's capabilities and the software you are using.

Specifications are subject to change without notice.

Noise	Less than 64 dB
Operating environment	Temperature: 10°C to 32.5°C (50°F to 90.5°F) Humidity: 20% to 80% RH (20% to 50% RH when using the imprinter)

Index

A			
AC Adapter Specifications	42		
Adjusting the Print Position.....	16, 39		
Amount loaded	23		
Auto Power Off	27		
C			
Cleaning			
Main unit.....	32		
Cleaning the Inside of the Scanner	32		
Connectors/Power Switch	15		
D			
Daily Cleaning	32		
Disc.....	3		
Disposal.....	10		
Document Eject Opening.....	13		
Document Feed Opening	13		
Document Feed Tray.....	13		
Documents	22		
Document.....	22		
How to place documents.....	23		
Double Feed Detection.....	23		
E			
Eject Stopper	13		
Exterior Dimensions	15		
F			
Features of the CR-L1	12		
Feeding Roller	14		
Feeding Trouble	30		
H			
Handling	10		
I			
Imprinter Cover.....	13		
Ink Absorber	14		
Ink Cartridge	14, 16, 37		
Ink Jet Nozzle.....	34		
Installation Location.....	11		
L			
Lock Lever	14		
		Long Document Mode	25
M			
Magnetic head	34		
Magnetic Head for MICR	14		
Maintenance	37		
Maintenance Cover	13		
Moving the Scanner.....	11		
N			
Number of pages loaded	23		
O			
Operating Environment.....	5		
P			
Paper Thickness Adjustment Dial.....	13		
Power Connector.....	15		
Power Cord.....	3, 6		
Power Indicator.....	13		
Power Supply	11		
Power Switch.....	15		
Print Position Adjustment Lever	14, 38		
R			
Reading Unit (Access Hatch)	15		
Recognizing the scanner	7		
Rollers	32		
S			
Scanning Glass	32		
Scanning Utility.....	5, 19		
Separation Roller.....	14		
Software			
How to Use the Software.....	19		
Install.....	5		
Uninstall.....	20		
Specifications	42		
T			
The Scanner Does Not Turn ON	30		
Troubleshooting.....	27		
Turning OFF the Power	7		
Turning ON the Power.....	7		

U

Unpacking the scanner.....	3
USB Connections	6, 28
USB Connector.....	15
UV scanning.	12

Safety-related markings on the machine

Marquages de sécurité sur la machine

Marcatore di sicurezza sulla macchina

Sicherheitshinweise auf der Maschine

Marcas de la máquina relacionadas con la seguridad

Veiligheidsmarkeringen op de machine

Makine üzerindeki güvenlik işaretleri



[English]	Switch (On)	Power on
[Français]	Commutateur (Marche)	Sous tension
[Italiano]	Interruttore (On)	Alimentazione presente
[Deutsch]	Schalter (Ein)	Eingeschaltet
[Español]	Interruptor (encendido)	Máquina encendida
[Nederlands]	Schakelaar (On)	Aan
[Türkçe]	Anahtar (Açık)	Güç açık



[English]	Switch (Off)	Power off (no standby current)
[Français]	Commutateur (Arrêt)	Hors tension (pas de courant de veille)
[Italiano]	Interruttore (Off)	Alimentazione assente (nessuna corrente di standby)
[Deutsch]	Schalter (Aus)	Ausgeschaltet (ohne Ruhestromaufnahme)
[Español]	Interruptor (apagado)	Máquina apagada (sin corriente en espera)
[Nederlands]	Schakelaar (Off)	Uit (geen stand-byverbruik)
[Türkçe]	Anahtar (Kapalı)	Güç kapalı (bekleme akımı yok)



[English]	Switch (Standby)	Power on/off (standby current on)
[Français]	Commutateur (Veille)	Sous/hors tension (courant de veille activé)
[Italiano]	Interruttore (Standby)	Alimentazione on/off (corrente di standby presente)
[Deutsch]	Schalter (Standby)	Ein- und Ausschalten (mit Ruhestromaufnahme)
[Español]	Interruptor (en espera)	Máquina apagada/encendida (con corriente en espera)
[Nederlands]	Schakelaar (Standby)	Aan-uit (stand-byverbruik aan)
[Türkçe]	Anahtar (Bekleme)	Güç açık/kapalı (bekleme akımı açık)





[English]	Switch (Push-On/Push-Off)	Power on/off (no standby current)
[Français]	Commutateur (Appuyer pour mettre en marche/Appuyer pour arrêter)	Sous/hors tension (pas de courant de veille)
[Italiano]	Interruttore a pulsante bistabile (On/Off)	Alimentazione on/off (nessuna corrente di standby)
[Deutsch]	Schalter (Ein- und Ausschalten durch Drücken)	Ein- und Ausschalten (ohne Ruhestromaufnahme)
[Español]	Interruptor (pulsado para encendido/apagado)	Encendido/apagado (sin corriente en espera)
[Nederlands]	Schakelaar (Push-On/Push-Off)	Aan-uit (geen stand-byverbruik)
[Türkçe]	Anahtar (Bas-Aç/Bas-Kapa)	Güç açık/kapalı (bekleme akımı yok)



[English]	Heat hazard	Heat hazard
[Français]	Danger de chaleur	Danger de chaleur
[Italiano]	Pericolo: temperature elevate	Pericolo: temperature elevate
[Deutsch]	Überhitzungsgefahr	Überhitzungsgefahr
[Español]	Peligro de calentamiento	Peligro de calentamiento
[Nederlands]	Verbrandingsgevaar	Verbrandingsgevaar
[Türkçe]	Isı tehlikesi	Isı tehlikesi



[English]	Class II equipment	Indicates this is Class II equipment
[Français]	Équipement de classe II	Indique qu'il s'agit d'un équipement de classe II
[Italiano]	Apparecchio classe II	Indica che questo è un apparecchio di classe II
[Deutsch]	Gerät der Schutzklasse II	Gibt an, dass das Gerät der Schutzklasse II entspricht
[Español]	Equipo de clase II	Indica que se trata de un equipo de clase II
[Nederlands]	Klassell-apparatuur	Geeft aan dat deze apparatuur in Klasse II hoort
[Türkçe]	Sınıf II ekipman	Bunun Sınıf II ekipman olduğunu gösterir

	[English]	DC symbol	Indicates direct current
	[Français]	Symbole CC	Indique qu'il s'agit de courant continu
	[Italiano]	Simbolo corrente continua (C.C.)	Indica la corrente continua
	[Deutsch]	Gleichstrom-Symbol	Kennzeichnet Gleichstrom
	[Español]	Símbolo CC	Indica corriente continua
	[Nederlands]	DC-pictogram	Geeft gelijkstroom aan
[Türkçe]	DC sembolü	Düz akımı gösterir	
	[English]	DC polarity	Indicates the power plug polarity
	[Français]	Polarité CC	Indique la polarité de la fiche d'alimentation
	[Italiano]	Polarità C.C.	Indica la polarità dello spinotto di alimentazione
	[Deutsch]	Gleichstrompolarität	Gibt die Polarität des Netzsteckers an
	[Español]	Polaridad de CC	Indica la polaridad del conector de alimentación
	[Nederlands]	DC-polariteit	Geeft de polariteit van de stekker aan
[Türkçe]	DC polaritesi	Fiş polaritesini gösterir	
	[English]	Electrostatic precaution	Avoid applying static electricity to the machine
	[Français]	Précaution électrostatique	Évitez de soumettre cette machine à de l'électricité statique
	[Italiano]	Protezione dalle cariche elettrostatiche	Evitare di applicare cariche elettrostatiche alla macchina
	[Deutsch]	Warnung vor elektrostatischer Aufladung	Elektrostatische Aufladung der Maschine vermeiden
	[Español]	Precaución electroestática	No aplique electricidad electroestática
	[Nederlands]	Elektrostatische voorzorgen	Voorkom statische elektriciteit op de machine
[Türkçe]	Elektrostatik önlemleri	Makineye statik elektrik vermeyin	



CANON ELECTRONICS INC.

3-5-10 SHIBAKOEN, MINATO-KU, TOKYO 105-0011, JAPAN

CANON U.S.A. INC.

ONE CANON PARK, MELVILLE, NY 11747, U.S.A.

CANON CANADA INC.

8000 MISSISSAUGA ROAD, BRAMPTON, ONTARIO L6Y 5Z7, CANADA

CANON EUROPA N.V.

BOVENKERKERWEG 59, 1185 XB AMSTELVEEN, THE NETHERLANDS

CANON AUSTRALIA PTY. LTD.

BUILDING A, THE PARK ESTATE, 5 TALAVERA ROAD, MACQUARIE PARK, NSW 2113, AUSTRALIA

CANON SINGAPORE PTE. LTD.

1 FUSIONPOLIS PLACE, #15-10, GALAXIS, SINGAPORE 138522

CANON INDIA PVT. LTD

7TH FLOOR, TOWER B DLF CYBER TERRACES DLF PHASE III GURGAON - 122002 HARYANA, INDIA

PUB. 6T3-0039-E1.00

© CANON ELECTRONICS INC. 2018