

# Verse Quick Connectors - QC90 and QC180

## Assembly Instructions

**QC90 - 90° Corner Connector** - Use for a 2 way, 3 way and 4 way corner connection or for multi-height corner connections.

**QC180 - 180° Straight Connector** - Use when connecting two panels together for a straight connection or for multi-height straight connections.

Tools required: None

### Installation:

- With help, align panels in a 90 or 180 degree configuration.
  - Make sure all panel glides are leveled at the same height.
  - Each 90 or 180 degree connection requires 2 brackets (1 pair) on each panel end. The location should be placed within 6" from the top edge (of the "smallest" panel in the configuration) and 6" from the bottom edge. (see FIG. 1)
  - Slip the ends of the connector between the fabricated part of the panel and the square tube and snap into place over the vertical square tube (see FIG. 2).
- NOTE: The connectors are secure in place after the "snap" has occurred.
- Snap the other end of the connectors into the other panel according to the configuration.

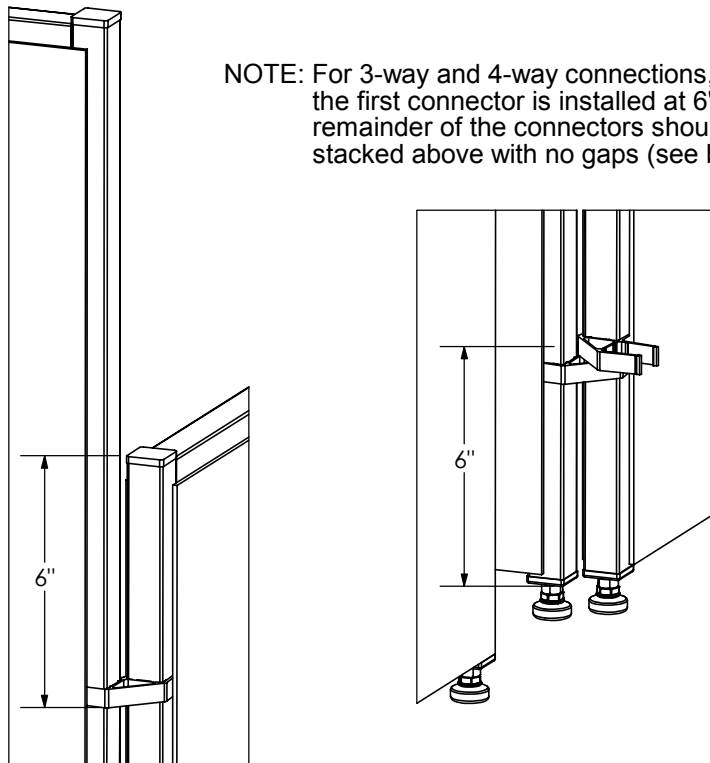

FIG. 1 Top and Bottom view

### Connection

Straight  
90° 2-way  
3-way  
4-way

### Connectors

1 pair - QC180  
1 pair - QC90  
2 pair - QC90  
3 pair - QC90

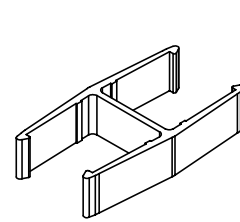

QC180

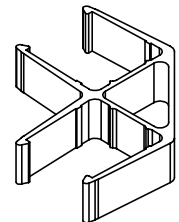

QC90

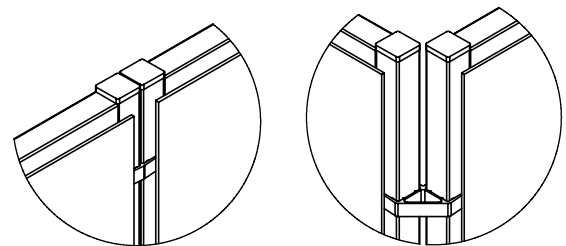

Completed connections

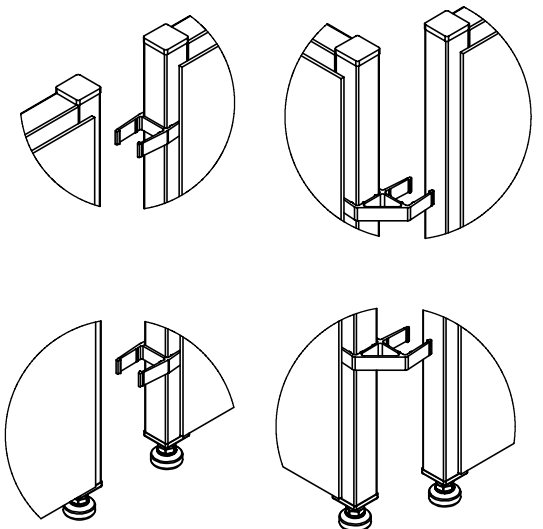

180° connection

90° connection

FIG. 2 Top and Bottom view

