

CYLINDER BASE

INSTALLATION INSTRUCTIONS

Illustration 1

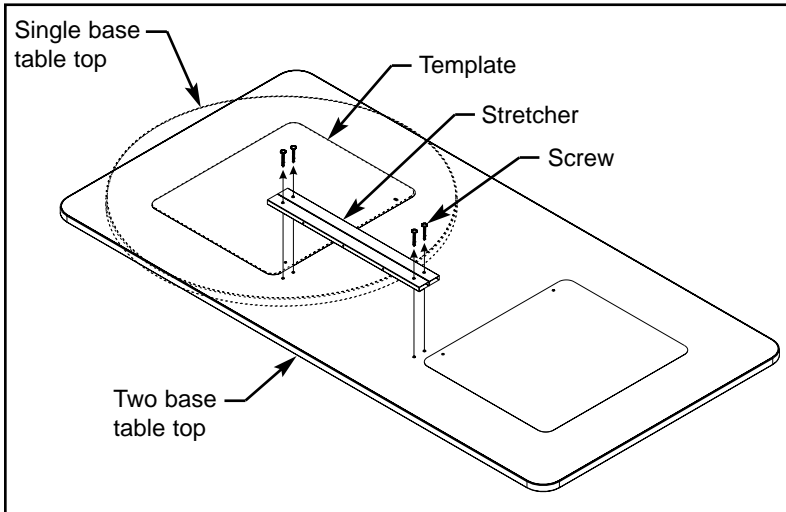
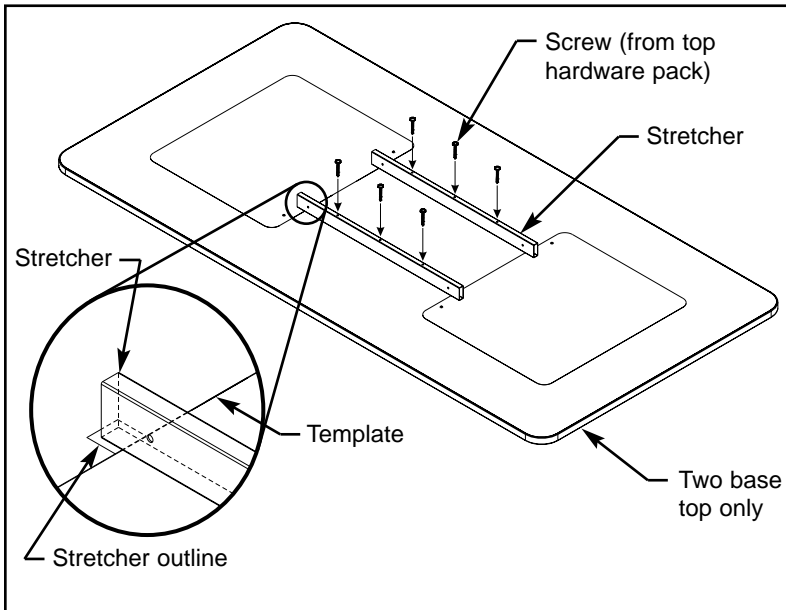

Illustration 2



Read all instructions and review illustrations before installing.

Tools required for assembly:
Power screwdriver
Phillips power driver
Safety glasses

Each base assembly includes:
(1) Cylinder base (5) Glide
(6) Sand bag (6) Screw

Single base top assembly includes:
(1) Top

Two base top assembly includes:
(1) Top (2) Stretcher
(2 - 10) Screw

⚠ WARNING

To prevent the possibility of serious eye injury, always wear eye protection when using power tools.

Heavy panels can pinch or crush fingers. do not place fingers between or under panels during assembly.

Table can become unstable and tip over resulting in severe injury to yourself or others. To inhibit tipping, evenly distribute 120 lb of clean dry sand inside each cylinder base before attaching table top.

Installation:

1. Refer to Illustration 1. Lay top, with template(s) facing up, on cardboard or a carpeted surface.
2. Refer to Illustration 1. On two base top only, use the power screwdriver with Phillips power driver to remove screws securing stretchers to bottom of table top.

NOTE

On 72" long two base tops, remove and discard stretchers. **Do not** reinstall stretchers onto 72" long two base tops.

3. Refer to Illustration 2. On two base tops only, locate stretcher outlines along front edge of each table top template. Position stretchers onto table top so that ends of stretchers align with stretcher outlines on table top templates.
4. Refer to Illustration 2. On two base tops only, use the power screwdriver with Phillips power driver to install screws (from top hardware pack) through holes in stretchers and into table top. Fully tighten screws.

CYLINDER BASE

Illustration 3

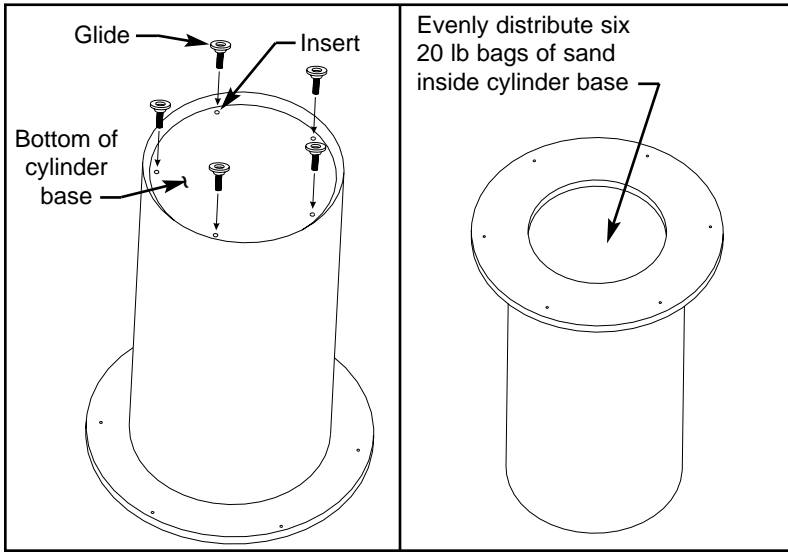
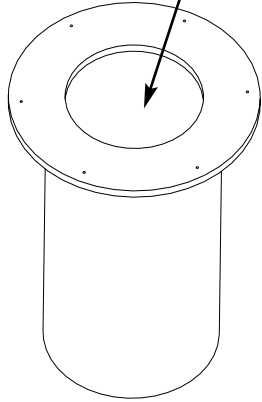

Illustration 4

Evenly distribute six 20 lb bags of sand inside cylinder base



5. Refer to Illustration 3. Locate glide inserts in bottom of cylinder base. Thread a glide (from base hardware pack) into each glide insert. Turn glides clockwise until glides are flat against bottom of cylinder base.
6. Set cylinder base upright and position base where table will be used.
7. Measure 12" from bottom of sand bags and mark bags with a felt tip pen. Fill sand bags to mark with 20 lb of clean dry sand and tie bags closed.
8. Refer to Illustration 4. Evenly distribute six 20 lb bags of clean dry sand inside cylinder base.
9. Repeat Steps 5 through 8 for each remaining base assembly.

Illustration 5

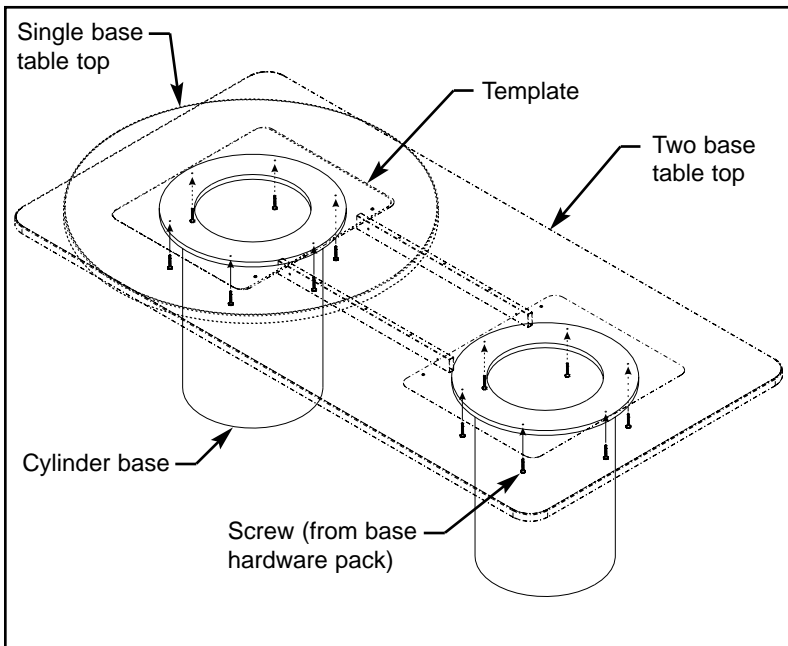

10. Refer to Illustration 5. Locate cylinder base outlines on table top template(s). Use two or more people to position table top onto cylinder base(s) and align base(s) within the cylinder base outline(s).
11. Refer to Illustration 5. Use the power screwdriver with Phillips power driver to install screws (from base hardware pack) through holes in cylinder base and into table top. Fully tighten screws.